

Pascal

Two-stage rotary vane pumps for low and medium vacuum



Pascal

Two-stage Pascal rotary vane pumps are the result of decades of experience in the design and industrial production of vacuum pumps.

Pumps in the Pascal series with a pumping speed between 5 and 60 m³/h are used in the most demanding applications in industry, analytics and research & development.

They are distinguished by their high quality and reliability. Four versions of oil-lubricated Pascal pumps allow for optimal adjustment to different requirements. The following versions are available:

- SD-version for all vacuum applications with non-corrosive gases
- I-version for the requirements of instrumental analytics
- C1-version for applications with aggressive or corrosive gases
- C2-version for harsh duty applications with the most aggressive pumping environment

Customer benefits

- High process reliability
- Easy to use and integrate
- Low oil back-streaming
- Low cost of ownership

Typical applications

- Electron microscopy
- Residual gas analysis
- Hard disk coating
- Wear protection
- CD, DVD, Blu-ray production
- Optical coatings
- Vacuum drying
- Space simulation
- Medical applications



Medical applications



Microscopy



Wear protection



Pascal 2005

Two-stage Rotary Vane pumps for all major vacuum applications in a wide range of industries.



- All major vacuum applications in a wide range of industries
- No oil mist pollution at the exhaust for 5 - 21 m³/h pumps: thanks to the natural lubrication design, even with high throughputs or frequent cycling
- Low backstreaming rate
- Compact design
- Adjustable inlet and outlet ports, horizontal or vertical orientation for better integration
- Universal 1-phase motors (high & low voltage, 50/60 Hz)
- Easy integration by large OEMs

SD, I, C1 versions are delivered with mineral oil, and C2 versions are prepared for operation with PFPE oil but fluid must be ordered separately

Pumping speed

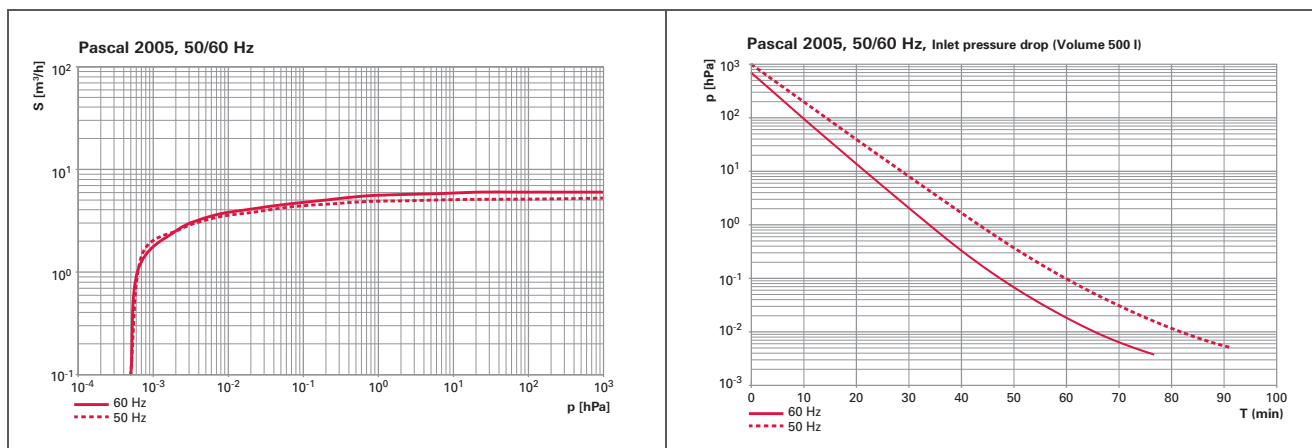

Pascal 2005

Pascal 2005

Dimensions (in mm)

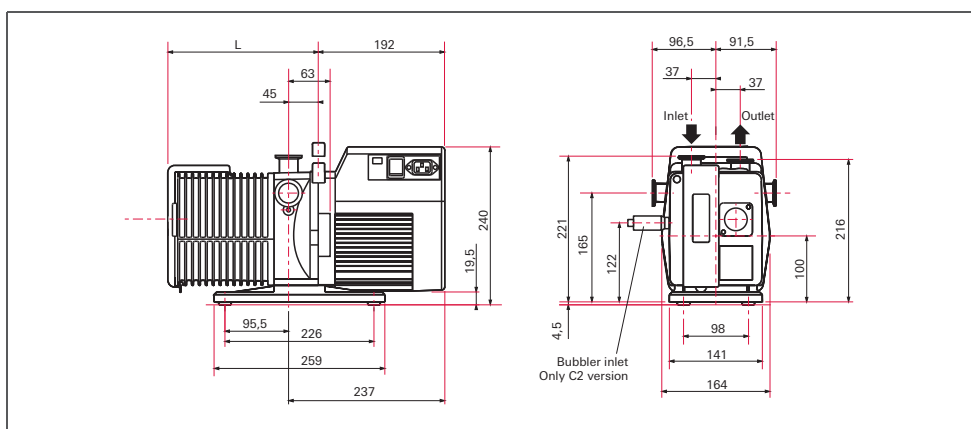

Pascal 2005	
L	228 mm



Technical data	Pascal 2005, 1-phase motor, 180-254 V, 50 Hz/60 Hz, CE/UL/CSA	Pascal 2005, 1-phase motor, 90-132 V, 50 Hz/60 Hz, CE/UL/CSA	Pascal 2005, 3-phase motor, 342-460 V, 50 Hz; 342-520 V, 60 Hz, CE/UL/CSA	Pascal 2005, 3-phase motor, 170-254 V, 50 Hz; 170-300 V, 60 Hz, CE/UL/CSA
Flange (out)	DN 25 ISO-KF	DN 25 ISO-KF	DN 25 ISO-KF	DN 25 ISO-KF
Flange (in)	DN 25 ISO-KF	DN 25 ISO-KF	DN 25 ISO-KF	DN 25 ISO-KF
Operating fluid	Mineral oil	Mineral oil	Mineral oil	Mineral oil
Ultimate pressure with gas ballast	10 ⁻² hPa	10 ⁻² hPa	10 ⁻² hPa	10 ⁻² hPa
Weight	25 kg	25 kg	25 kg	25 kg
Rated power 50 Hz	0.45 kW	0.45 kW	0.55 kW	0.55 kW
Rated power 60 Hz	0.55 kW	0.55 kW	0.66 kW	0.66 kW
Pumping speed at 50 Hz	5 m ³ /h	5 m ³ /h	5 m ³ /h	5 m ³ /h
Pumping speed at 60 Hz	6 m ³ /h	6 m ³ /h	6 m ³ /h	6 m ³ /h

Order number				
Pascal 2005 SD (5 m ³ /h)	205SDMHEM	205SDMLAM	205SDTHEM	205SDTLAM
Pascal 2005 I (5 m ³ /h)	205AEMHEM	205AEMLAM	205AETHEM	205AETLAM

Accessories				
Oil mist eliminator OME 25 S	104200	104200	104200	104200
Oil mist eliminator OME 25 HP	104199	104199	104199	104199
Oil mist eliminator OME 25 HP+	108341	108341	108341	108341
Oil drain kit ODK 1	104360	104360	104360	104360
Oil drain kit ODK 2, 230 V, 50/60 Hz	104361	104361	104361	104361
Sorption trap ST 25 S	104107	104107	104107	104107
Inlet dust filter DFT 25	104202	104202	104202	104202
Liquid nitrogen trap LNT 25 S	104197	104197	104197	104197
Liquid nitrogen trap LNT 25 P1	786346	786346	786346	786346
Condensate trap CT 25	104201	104201	104201	104201
Automatic gas ballast AGB 4, 230 V, 50/60 Hz	104086	104086	104086	104086
Oil level switch OLS 4	104376	104376	104376	104376

Order number				
Pascal 2005 C1 (5 m ³ /h)	205C1MHEM	205C1MLAM	205C1THEM	205C1TLAM

Accessories				
Oil mist eliminator OME 25 C/H	066849	066849	066849	066849
Sorption trap ST 25 C, 220 V	066841	066841	066841	066841
Liquid nitrogen trap LNT 25 C	066889	066889	066889	066889
External oil filter DE 1, 230 V, 50 Hz	068990	068990	068990	068990



Pascal 2010

Two-stage Rotary Vane pumps for all major vacuum applications in a wide range of industries.



- All major vacuum applications in a wide range of industries
- No oil mist pollution at the exhaust for 5 - 21 m³/h pumps: thanks to the natural lubrication design, even with high throughputs or frequent cycling
- Low backstreaming rate
- Compact design
- Adjustable inlet and outlet ports, horizontal or vertical orientation for better integration
- Universal 1-phase motors (high & low voltage, 50/60 Hz)
- Easy integration by large OEMs

SD, I, C1 versions are delivered with mineral oil, and C2 versions are prepared for operation with PFPE oil but fluid must be ordered separately

Pumping speed

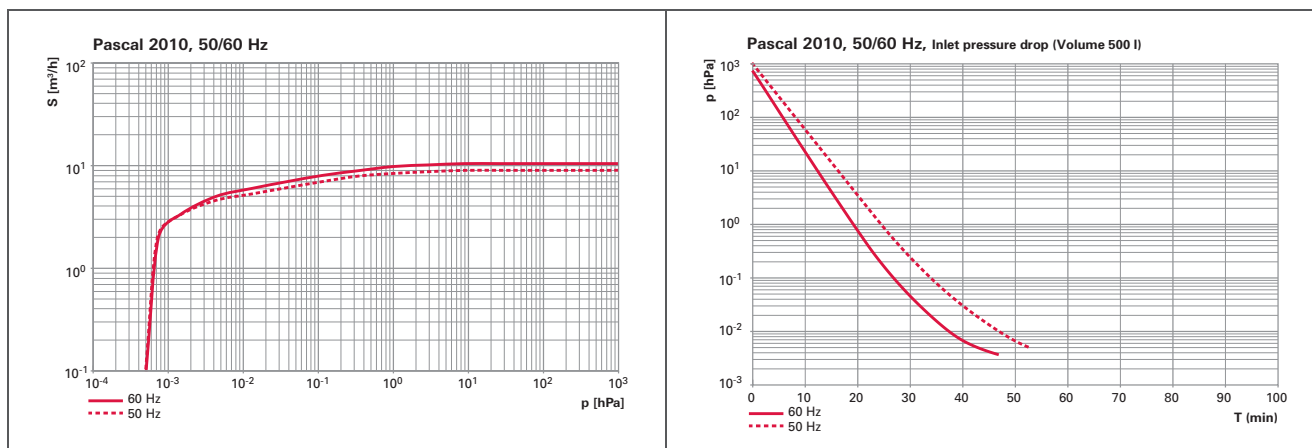

Pascal 2010

Pascal 2010

Dimensions (in mm)

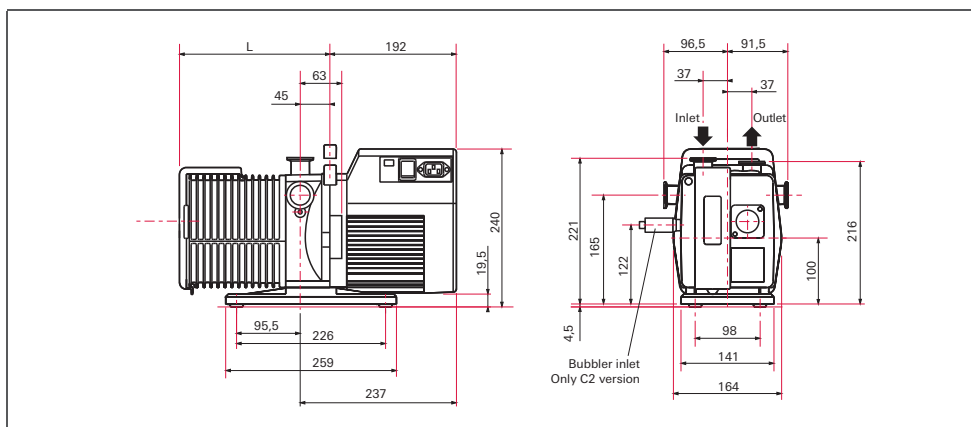

Pascal 2010	
L	245 mm



Technical data	Pascal 2010, 1-phase motor, 180-254 V, 50 Hz/60 Hz, CE/UL/CSA	Pascal 2010, 1-phase motor, 90-132 V, 50 Hz/60 Hz, CE/UL/CSA	Pascal 2010, 3-phase motor, 342-460 V, 50 Hz; 342-520 V, 60 Hz, CE/UL/CSA	Pascal 2010, 3-phase motor, 170-254 V, 50 Hz; 170-300 V, 60 Hz, CE/UL/CSA
Flange (out)	DN 25 ISO-KF	DN 25 ISO-KF	DN 25 ISO-KF	DN 25 ISO-KF
Flange (in)	DN 25 ISO-KF	DN 25 ISO-KF	DN 25 ISO-KF	DN 25 ISO-KF
Operating fluid	Mineral oil	Mineral oil	Mineral oil	Mineral oil
Ultimate pressure with gas ballast	10 ⁻² hPa	10 ⁻² hPa	10 ⁻² hPa	10 ⁻² hPa
Weight	26 kg	26 kg	26 kg	26 kg
Rated power 50 Hz	0.45 kW	0.45 kW	0.55 kW	0.55 kW
Rated power 60 Hz	0.55 kW	0.55 kW	0.66 kW	0.66 kW
Pumping speed at 50 Hz	9 m ³ /h	9 m ³ /h	9 m ³ /h	9 m ³ /h
Pumping speed at 60 Hz	10.5 m ³ /h	10.5 m ³ /h	10.5 m ³ /h	10.5 m ³ /h

Order number				
Pascal 2010 SD (10 m ³ /h)	210SDMHEM	210SDMLAM	210SDTHEM	210SDTLAM
Pascal 2010 I (10 m ³ /h)	210AEMHEM	210AEMLAM	210AETHEM	210AETLAM

Accessories				
Oil mist eliminator OME 25 S	104200	104200	104200	104200
Oil mist eliminator OME 25 HP	104199	104199	104199	104199
Oil mist eliminator OME 25 HP+	108341	108341	108341	108341
Oil drain kit ODK 1	104360	104360	104360	104360
Oil drain kit ODK 2, 230 V, 50/60 Hz	104361	104361	104361	104361
Sorption trap ST 25 S	104107	104107	104107	104107
Inlet dust filter DFT 25	104202	104202	104202	104202
Liquid nitrogen trap LNT 25 S	104197	104197	104197	104197
Liquid nitrogen trap LNT 25 P1	786346	786346	786346	786346
Condensate trap CT 25	104201	104201	104201	104201
Automatic gas ballast AGB 4, 230 V, 50/60 Hz	104086	104086	104086	104086
Oil level switch OLS 4	104376	104376	104376	104376

Order number				
Pascal 2010 C1 (10 m ³ /h)	210C1MHEM	210C1MLAM	210C1THEM	210C1TLAM
Pascal 2010 C2 (10 m ³ /h)	210C2MHEN	210C2MLAN	210C2THEN	210C2TLAN

Accessories				
Sorption trap ST 25 C, 220 V	066841	066841	066841	066841
Liquid nitrogen trap LNT 25 C	066889	066889	066889	066889
External oil filter DE 1, 230 V, 50 Hz	068990	068990	068990	068990



Pascal 2015

Two-stage Rotary Vane pumps for all major vacuum applications in a wide range of industries.



- All major vacuum applications in a wide range of industries
- No oil mist pollution at the exhaust for 5 - 21 m³/h pumps: thanks to the natural lubrication design, even with high throughputs or frequent cycling
- Low backstreaming rate
- Compact design
- Adjustable inlet and outlet ports, horizontal or vertical orientation for better integration
- Universal 1-phase motors (high & low voltage, 50/60 Hz)
- Easy integration by large OEMs

SD, I, C1 versions are delivered with mineral oil, and C2 versions are prepared for operation with PFPE oil but fluid must be ordered separately

Pumping speed

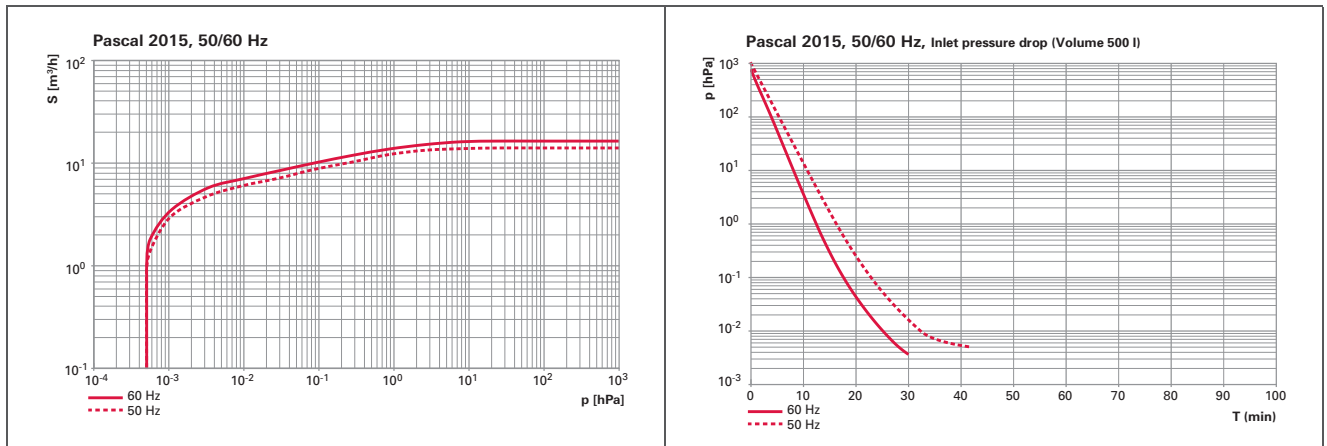

Pascal 2015

Pascal 2015

Dimensions (in mm)

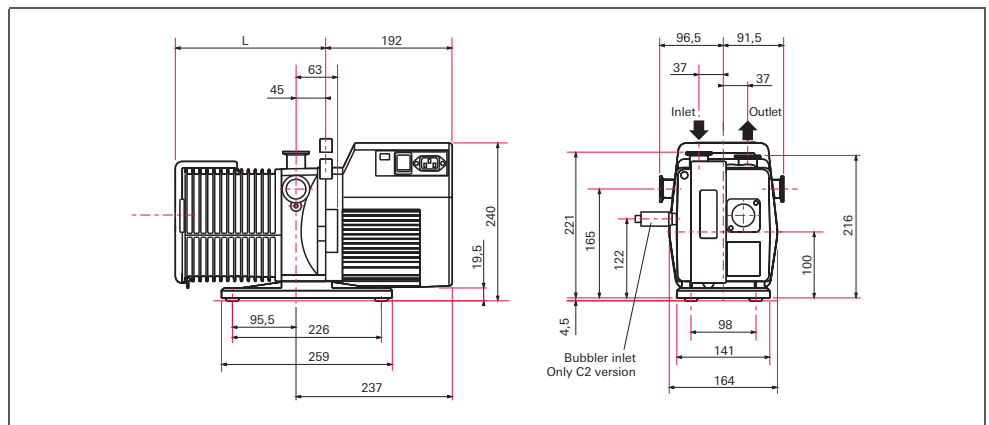

	Pascal 2015
L	270 mm



Technical data	Pascal 2015, 1-phase motor, 180-254 V, 50 Hz/60 Hz, CE/UL/CSA	Pascal 2015, 1-phase motor, 90-132 V, 50 Hz/60 Hz, CE/UL/CSA	Pascal 2015, 3-phase motor, 342-460 V, 50 Hz; 342-520 V, 60 Hz, CE/UL/CSA	Pascal 2015, 3-phase motor, 170-254 V, 50 Hz; 170-300 V, 60 Hz, CE/UL/CSA
Flange (out)	DN 25 ISO-KF	DN 25 ISO-KF	DN 25 ISO-KF	DN 25 ISO-KF
Flange (in)	DN 25 ISO-KF	DN 25 ISO-KF	DN 25 ISO-KF	DN 25 ISO-KF
Operating fluid	Mineral oil	Mineral oil	Mineral oil	Mineral oil
Ultimate pressure with gas ballast	10 ⁻² hPa	10 ⁻² hPa	10 ⁻² hPa	10 ⁻² hPa
Weight	27 kg	27 kg	27 kg	27 kg
Rated power 50 Hz	0.45 kW	0.45 kW	0.55 kW	0.55 kW
Rated power 60 Hz	0.55 kW	0.55 kW	0.66 kW	0.66 kW
Pumping speed at 50 Hz	14 m ³ /h	14 m ³ /h	14 m ³ /h	14 m ³ /h
Pumping speed at 60 Hz	16.5 m ³ /h	16.5 m ³ /h	16.5 m ³ /h	16.5 m ³ /h

Order number				
Pascal 2015 SD (15 m ³ /h)	215SDMHEM	215SDMLAM	215SDTHEM	215SDTLAM
Pascal 2015 I (15 m ³ /h)	215AEMHEM	215AEMLAM	215AETHEM	215AETLAM

Accessories				
Oil mist eliminator OME 25 S	104200	104200	104200	104200
Oil mist eliminator OME 25 HP	104199	104199	104199	104199
Oil mist eliminator OME 25 HP+	108341	108341	108341	108341
Oil drain kit ODK 1	104360	104360	104360	104360
Oil drain kit ODK 2, 230 V, 50/60 Hz	104361	104361	104361	104361
Sorption trap ST 25 S	104107	104107	104107	104107
Inlet dust filter DFT 25	104202	104202	104202	104202
Liquid nitrogen trap LNT 25 S	104197	104197	104197	104197
Liquid nitrogen trap LNT 25 P1	786346	786346	786346	786346
Condensate trap CT 25	104201	104201	104201	104201
Automatic gas ballast AGB 4, 230 V, 50/60 Hz	104086	104086	104086	104086
Oil level switch OLS 4	104376	104376	104376	104376

Order number				
Pascal 2015 C1 (15 m ³ /h)	215C1MHEM	215C1MLAM	215C1THEM	215C1TLAM
Pascal 2015 C2 (15 m ³ /h)	215C2MHEN	215C2MLAN	215C2THEN	215C2TLAN

Accessories				
Sorption trap ST 25 C, 220 V	066841	066841	066841	066841
Liquid nitrogen trap LNT 25 C	066889	066889	066889	066889
External oil filter DE 1, 230 V, 50 Hz	068990	068990	068990	068990



Pascal 2021

Two-stage Rotary Vane pumps for all major vacuum applications in a wide range of industries.



- All major vacuum applications in a wide range of industries
- No oil mist pollution at the exhaust for 5 - 21 m³/h pumps: thanks to the natural lubrication design, even with high throughputs or frequent cycling
- Low backstreaming rate
- Compact design
- Adjustable inlet and outlet ports, horizontal or vertical orientation for better integration
- Universal 1-phase motors (high & low voltage, 50/60 Hz)
- Easy integration by large OEMs

SD, I, C1 versions are delivered with mineral oil, and C2 versions are prepared for operation with PFPE oil but fluid must be ordered separately

Pumping speed

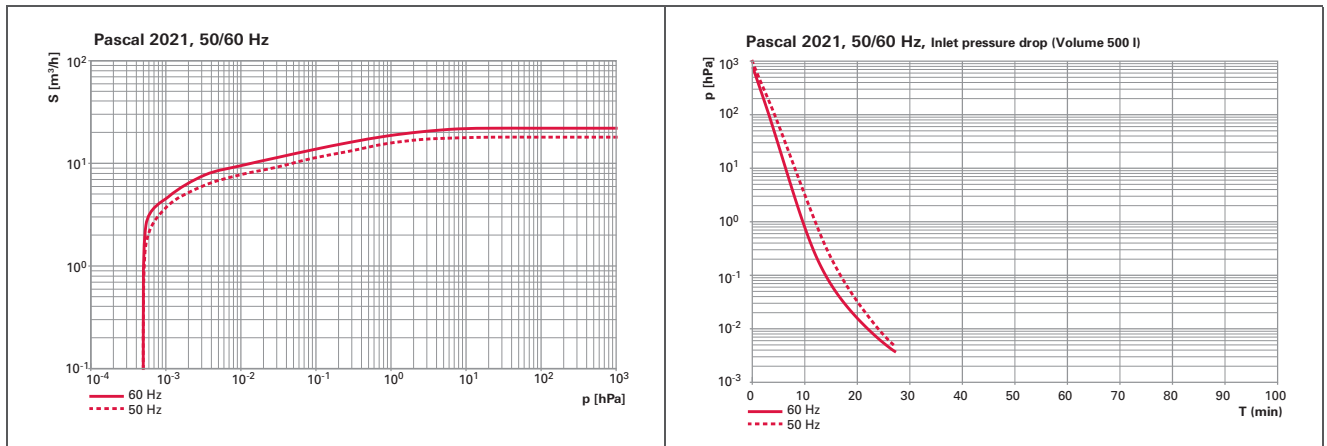

Pascal 2021

Pascal 2021

Dimensions (in mm)

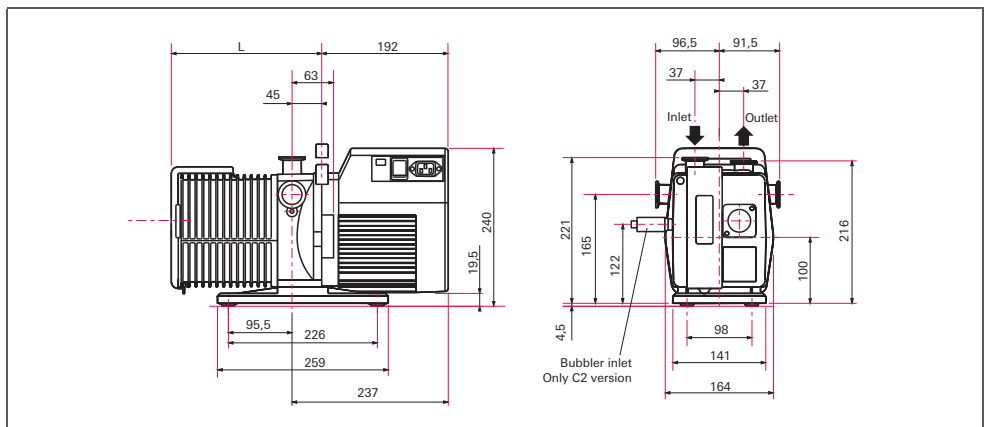

Pascal 2021	
L	291 mm



Technical data	Pascal 2021, 1-phase motor, 180-254 V, 50 Hz/60 Hz, CE/UL/CSA	Pascal 2021, 1-phase motor, 90-132 V, 50 Hz/60 Hz, CE/UL/CSA	Pascal 2021, 3-phase motor, 342-460 V, 50 Hz; 342-520 V, 60 Hz, CE/UL/CSA	Pascal 2021, 3-phase motor, 170-254 V, 50 Hz; 170-300 V, 60 Hz, CE/UL/CSA
Flange (out)	DN 25 ISO-KF	DN 25 ISO-KF	DN 25 ISO-KF	DN 25 ISO-KF
Flange (in)	DN 25 ISO-KF	DN 25 ISO-KF	DN 25 ISO-KF	DN 25 ISO-KF
Operating fluid	Mineral oil	Mineral oil	Mineral oil	Mineral oil
Ultimate pressure with gas ballast	10 ⁻² hPa	10 ⁻² hPa	10 ⁻² hPa	10 ⁻² hPa
Weight	28 kg	28 kg	28 kg	28 kg
Rated power 50 Hz	0.45 kW	0.45 kW	0.55 kW	0.55 kW
Rated power 60 Hz	0.55 kW	0.55 kW	0.66 kW	0.66 kW
Pumping speed at 50 Hz	18 m ³ /h	18 m ³ /h	18 m ³ /h	18 m ³ /h
Pumping speed at 60 Hz	22 m ³ /h	22 m ³ /h	22 m ³ /h	22 m ³ /h

Order number				
Pascal 2021 SD (21 m ³ /h)	221SDMHEM	221SDMLAM	221SDTHEM	221SDTLAM
Pascal 2021 I (21 m ³ /h)	221AEMHEM	221AEMLAM	221AETHEM	221AETLAM

Accessories				
Oil mist eliminator OME 25 S	104200	104200	104200	104200
Oil mist eliminator OME 25 HP	104199	104199	104199	104199
Oil mist eliminator OME 25 HP+	108341	108341	108341	108341
Oil drain kit ODK 1	104360	104360	104360	104360
Oil drain kit ODK 2, 230 V, 50/60 Hz	104361	104361	104361	104361
Sorption trap ST 25 S	104107	104107	104107	104107
Inlet dust filter DFT 25	104202	104202	104202	104202
Liquid nitrogen trap LNT 25 S	104197	104197	104197	104197
Liquid nitrogen trap LNT 25 P1	786346	786346	786346	786346
Condensate trap CT 25	104201	104201	104201	104201
Automatic gas ballast AGB 4, 230 V, 50/60 Hz	104086	104086	104086	104086
Oil level switch OLS 4	104376	104376	104376	104376

Order number				
Pascal 2021 C1 (21 m ³ /h)	221C1MHEM	221C1MLAM	221C1THEM	221C1TLAM
Pascal 2021 C2 (21 m ³ /h)	221C2MHEN	221C2MLAN	221C2THEN	221C2TLAN

Accessories				
Sorption trap ST 25 C, 220 V	066841	066841	066841	066841
Liquid nitrogen trap LNT 25 C	066889	066889	066889	066889
External oil filter DE 1, 230 V, 50 Hz	068990	068990	068990	068990



Pascal 2033

Two-stage Rotary Vane pumps for all major vacuum applications in a wide range of industries.



- All major vacuum applications in a wide range of industries
- Low backstreaming rate

SD, I, C1 versions are delivered with mineral oil, and C2 versions are prepared for operation with PFPE oil but fluid must be ordered separately

Pumping speed

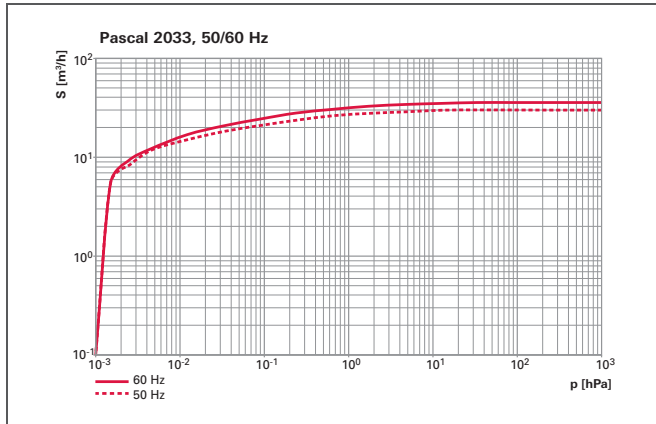

Pascal 2033

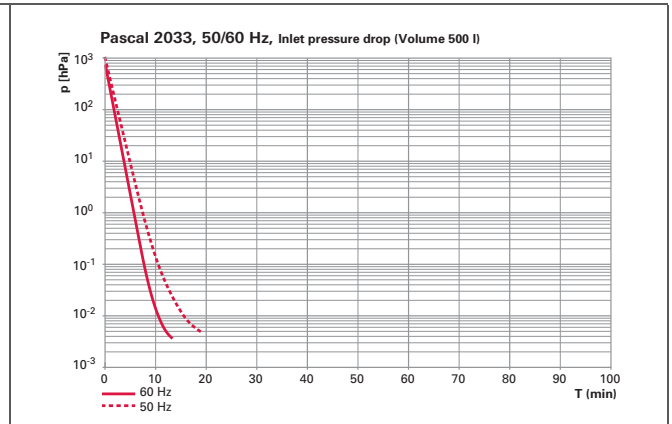

Pascal 2033

Dimensions (in mm)

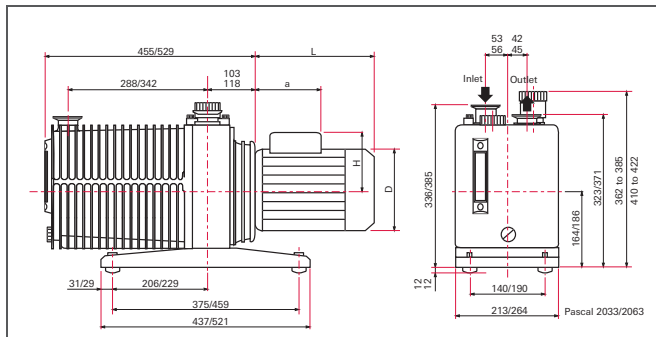

Pascal 2033, SD version

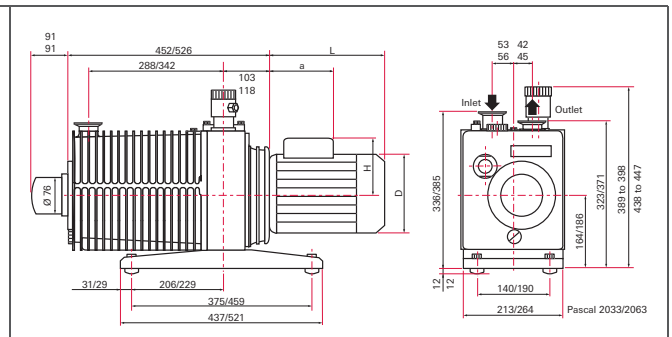

Pascal 2033, C1 version

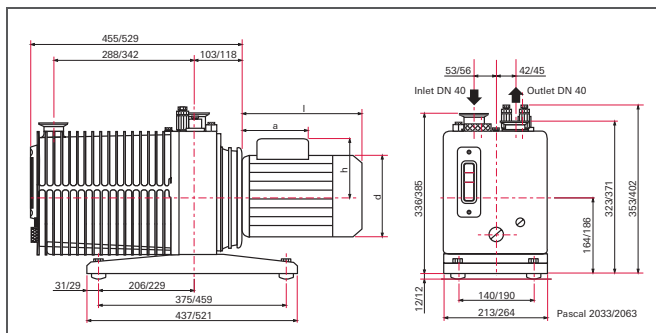

Pascal 2033, C2 version

	3-phase motor Europe	3-phase motor USA/Japan	3-phase motor Rest of the world
A	143 mm	143 mm	200 mm
D	177 mm	177 mm	170 mm
H	137 mm	137 mm	140 mm
L	267 mm	267 mm	270 mm

Technical data	Pascal 2033, 3-phase motor, Europe,	Pascal 2033, 3-phase motor, USA/Japan,	Pascal 2033, 3-phase motor, Rest of the world,	Pascal 2033, 3-phase motor, Rest of the world,
	380-415 V, 50 Hz; 380-480 V, 60 Hz, CE	180-220 V, 50 Hz; 190-230 V, 60 Hz, CE/UL/CSA	360-415 V, 50 Hz; 380-480 V, 60 Hz, CE	180-240 V, 50 Hz; 180-240 V, 60 Hz, CE
Flange (out)	DN 40 ISO-KF	DN 40 ISO-KF	DN 40 ISO-KF	DN 40 ISO-KF
Flange (in)	DN 40 ISO-KF	DN 40 ISO-KF	DN 40 ISO-KF	DN 40 ISO-KF
Operating fluid	Mineral oil	Mineral oil	Mineral oil	Mineral oil
Ultimate pressure with gas ballast	$2 \cdot 10^{-2}$ hPa	$2 \cdot 10^{-2}$ hPa	$2 \cdot 10^{-2}$ hPa	$2 \cdot 10^{-2}$ hPa
Rated power 50 Hz	1.1 kW	1.5 kW	1.5 kW	1.5 kW
Rated power 60 Hz	1.3 kW	1.8 kW	1.8 kW	1.8 kW
Pumping speed at 50 Hz	30 m ³ /h	30 m ³ /h	30 m ³ /h	30 m ³ /h
Pumping speed at 60 Hz	36 m ³ /h	36 m ³ /h	36 m ³ /h	36 m ³ /h

Order number				
Weight	65.5 kg	67.5 kg	69 kg	69 kg
Pascal 2033 SD (33 m ³ /h)	233SDT1HWMNX	233SDT2LWMNX	233SDT3HWMNX	233SDT3LWMNX

Accessories				
Oil mist eliminator OME 40 S	104887	104887	104887	104887
Oil mist eliminator OME 40 HP+	200024	200024	200024	200024
Oil drain kit ODK 136	118773	118773	118773	118773
Oil drain kit ODK 236, 230 V, 50/60 Hz	118776	118776	118776	118776
Sorption trap ST 40, 230 V (without adsorbent charge)	053380	053380	053380	053380
Automatic gas ballast AGB 36, 230 V, 50/60 Hz	068391	068391	068391	068391
Oil level switch OLS 36	104377	104377	104377	104377
External oil filter DE 1, 230 V, 50 Hz	068990	068990	068990	068990
External oil filter DE 2, 230 V, 50 Hz	104374	104374	104374	104374

Order number				
Weight	68,5 kg	70,5 kg	72 kg	72 kg
Pascal 2033 C1 (33 m ³ /h)	233C1T1HWMNX	233C1T2LWMNX	233C1T3HWMNX	233C1T3LWMNX
Weight	66,5 kg	68,5 kg	70 kg	70 kg
Pascal 2033 C2 (33 m ³ /h)	233C2T1HWNNX	233C2T2LWNNX	233C2T3HWNNX	233C2T3LWNNX

Accessories				
Oil mist eliminator OME 40 C1	068785	068785	068785	068785
External oil filter DE 1, 230 V, 50 Hz	068990	068990	068990	068990
External oil filter DE 2, 230 V, 50 Hz	104374	104374	104374	104374



Pascal 2063

Two-stage Rotary Vane pumps for all major vacuum applications in a wide range of industries.



- All major vacuum applications in a wide range of industries
- Low backstreaming rate

SD, I, C1 versions are delivered with mineral oil, and C2 versions are prepared for operation with PFPE oil but fluid must be ordered separately

Pumping speed

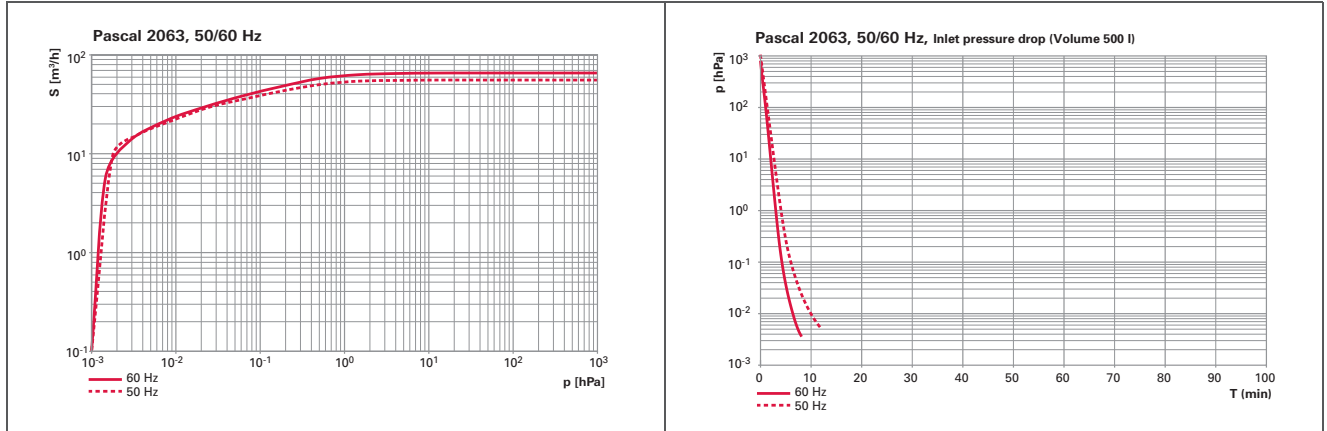

Pascal 2063

Pascal 2063

Dimensions (in mm)

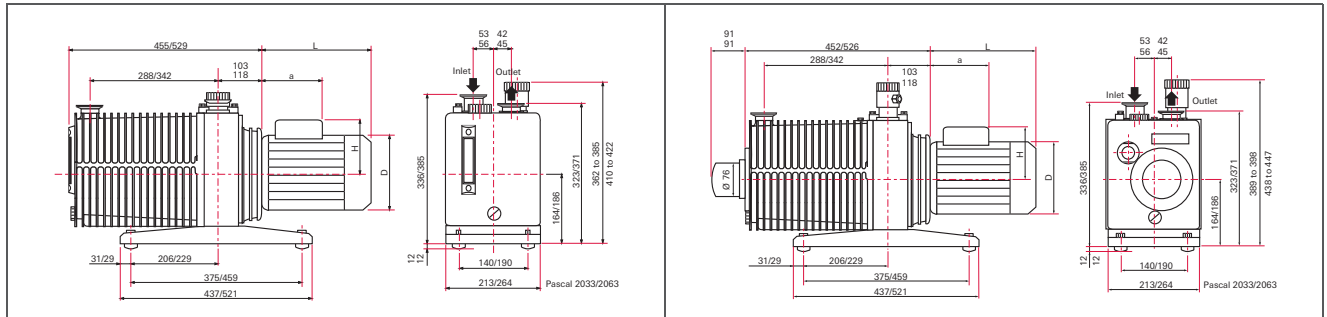

Pascal 2063, SD version

Pascal 2063, C1 version

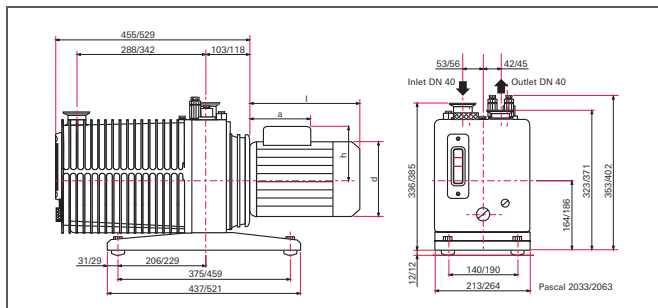

Pascal 2063, C2 version

	3-phase motor Europe	3-phase motor USA/Japan	3-phase motor Rest of the world
A	149 mm	149 mm	230 mm
D	196 mm	196 mm	190 mm
H	144 mm	144 mm	150 mm
L	321 mm	321 mm	300 mm



Technical data	Pascal 2063, 3-phase motor, Europe,	Pascal 2063, 3-phase motor, USA/Japan,	Pascal 2063, 3-phase motor, Rest of the world,	Pascal 2063, 3-phase motor, Rest of the world,
	380-415 V, 50 Hz; 380-480 V, 60 Hz, CE	180-220 V, 50 Hz; 190-280 V, 60 Hz, CE/UL/CSA	360-415 V, 50 Hz; 380-480 V, 60 Hz, CE	180-240 V, 50 Hz; 180-240 V, 60 Hz, CE
Flange (out)	DN 40 ISO-KF	DN 40 ISO-KF	DN 40 ISO-KF	DN 40 ISO-KF
Flange (in)	DN 40 ISO-KF	DN 40 ISO-KF	DN 40 ISO-KF	DN 40 ISO-KF
Operating fluid	Mineral oil	Mineral oil	Mineral oil	Mineral oil
Ultimate pressure with gas ballast	$2 \cdot 10^{-2}$ hPa	$2 \cdot 10^{-2}$ hPa	$2 \cdot 10^{-2}$ hPa	$2 \cdot 10^{-2}$ hPa
Rated power 50 Hz	2.2 kW	2.2 kW	2.2 kW	2.2 kW
Rated power 60 Hz	2.6 kW	2.6 kW	2.6 kW	2.6 kW
Mains requirement: voltage 50 Hz	380-415 V	180-220 V	360-415 V	180-240 V
Mains requirement: voltage 60 Hz	380-480 V	190-280 V	380-480 V	180-240 V
Pumping speed at 50 Hz	56 m ³ /h	56 m ³ /h	56 m ³ /h	56 m ³ /h
Pumping speed at 60 Hz	66 m ³ /h	66 m ³ /h	66 m ³ /h	66 m ³ /h

Order number				
Weight	104 kg	104 kg	103.5 kg	103.5 kg
Pascal 2063 SD (63 m ³ /h)	263SDT1HWMNX	263SDT2LWMNX	263SDT3HWMNX	263SDT3LWMNX

Accessories				
Oil mist eliminator OME 40 S	104887	104887	104887	104887
Oil mist eliminator OME 40 HP+	200024	200024	200024	200024
Oil drain kit ODK 136	118773	118773	118773	118773
Oil drain kit ODK 236, 230 V, 50/60 Hz	118776	118776	118776	118776
Sorption trap ST 40, 230 V (without adsorbent charge)	053380	053380	053380	053380
Automatic gas ballast AGB 36, 230 V, 50/60 Hz	068391	068391	068391	068391
Oil level switch OLS 36	104377	104377	104377	104377
External oil filter DE 1, 230 V, 50 Hz	068990	068990	068990	068990
External oil filter DE 2, 230 V, 50 Hz	104374	104374	104374	104374

Order number				
Weight	107,5 kg	107,5 kg	107 kg	107 kg
Pascal 2063 C1 (63 m ³ /h)	263C1T1HWMNX	263C1T2LWMNX	263C1T3HWMNX	263C1T3LWMNX
Weight	104,5 kg	104,5 kg	104 kg	104 kg
Pascal 2063 C2 (63 m ³ /h)	263C2T1HWNNX	263C2T2LWNNX	263C2T3HWNNX	263C2T3LWNNX

Accessories				
Oil mist eliminator OME 40 C1	068785	068785	068785	068785
External oil filter DE 1, 230 V, 50 Hz	068990	068990	068990	068990
External oil filter DE 2, 230 V, 50 Hz	104374	104374	104374	104374



Oil mist eliminator OME 25 S



Oil mist eliminators retain oil mist contained in the exhausted gases with a high level of separation; an internal over pressure valve prevents exceeding the maximum permissible exhaust pressure.

- Body material: Polyamide
- Cartridge material: Epoxy/glass microfiber
- Weight: 0.217 kg
- Inlet/Exhaust port: DN 25 ISO-KF
- Supplied with: 1 centering ring, 1 clamp, 1 additional angle port
- Replacement cartridge, single: Order number 068304. Orders must be placed for quantities multiple of 5 (5, 10, 15...)

Dimensions (in mm)

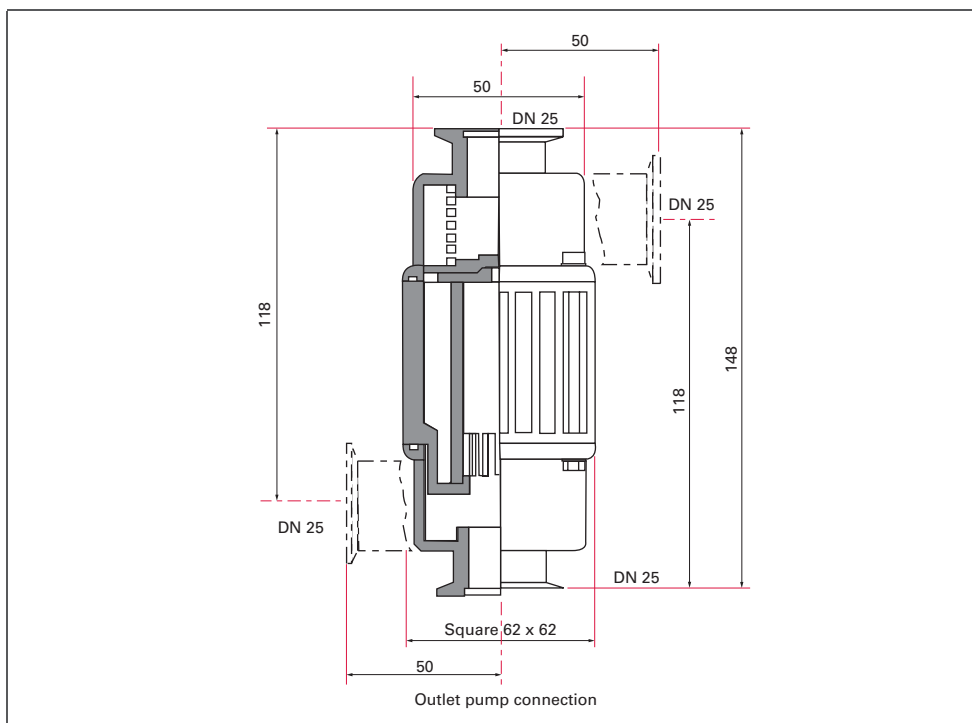

Order number	
Oil mist eliminator OME 25 S	104200



Oil mist eliminator OME 25 HP



Oil mist eliminators retain oil mist contained in the exhausted gases with a high level of separation; an internal over pressure valve prevents exceeding the maximum permissible exhaust pressure.

- Body material: Aluminum
- Cartridge material: Epoxy/glass microfiber
- Weight: 1.2 kg
- Inlet/Exhaust port: DN 25 ISO-KF
- Supplied with: 1 centering ring and 1 clamp
- Replacement cartridge (single): Order number 100522

Dimensions (in mm)

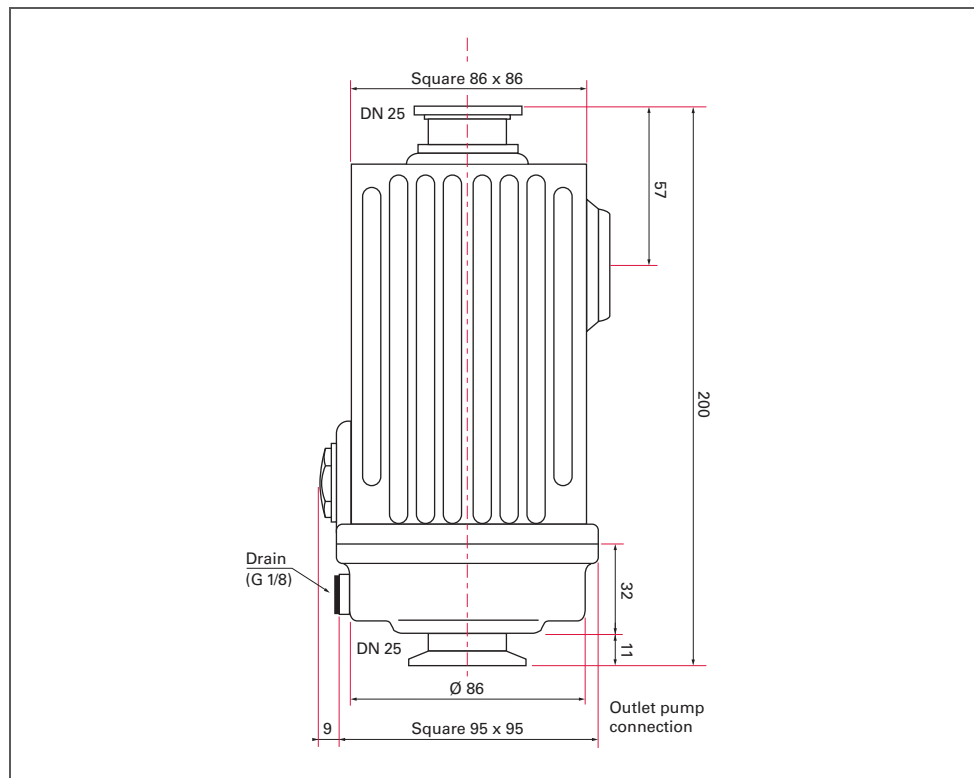

Order number	
Oil mist eliminator OME 25 HP	104199

Oil mist eliminator OME 25 HP+



Oil mist eliminators retain oil mist contained in the exhausted gases with a high level of separation; an internal over pressure valve prevents exceeding the maximum permissible exhaust pressure.

- Body material: Aluminum
- Cartridge material: PU/PET/glass micro-fiber/PA
- Weight: 1.2 kg
- Inlet/Exhaust port: DN 25 ISO-KF
- Supplied with: 1 centering ring and 1 clamp
- Replacement cartridge (single): Order number 107494

Order number	
Oil mist eliminator OME 25 HP+	108341



Oil mist eliminator OME 25 C/H



Oil mist eliminators retain oil mist contained in the exhausted gases with a high level of separation; an internal over pressure valve prevents exceeding the maximum permissible exhaust pressure.

- Body material: Stainless steel
- Cartridge material: PTFE/glass microfiber
- Weight: 0.53 kg
- Leak rate $< 2 \cdot 10^{-8}$ Pa m³/s
- Inlet/Exhaust port: DN 25 ISO-KF
- Supplied with: 1 centering ring and 1 clamp
- Replacement cartridge: Order number 066800

Dimensions (in mm)

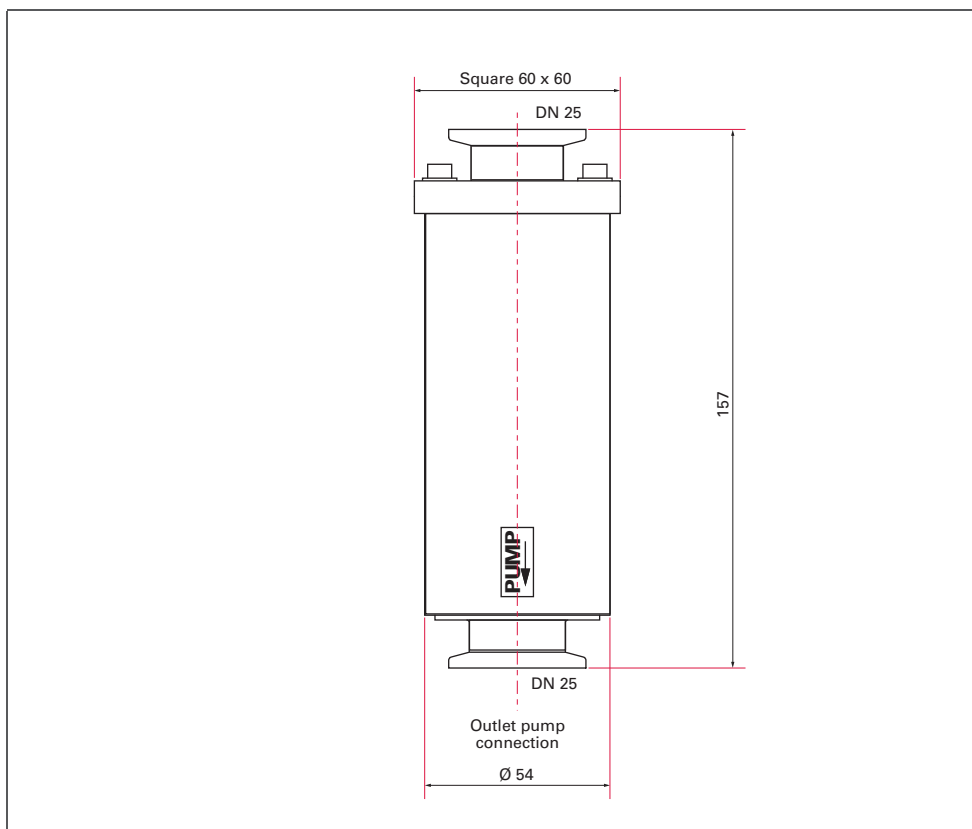

Order number	
Oil mist eliminator OME 25 C/H	066849



Oil mist eliminator OME40S



Oil mist eliminators retain oil mist contained in the exhausted gases with a high level of separation; an internal over pressure valve prevents exceeding the maximum permissible exhaust pressure.

- Body material: Aluminum
- Cartridge material: Epoxy/glass microfiber
- Weight: 0.9 kg
- Leak rate $< 2 \cdot 10^{-8}$ Pa m³/s
- Inlet/Exhaust port: DN 40 ISO-KF
- Replacement cartridge (single): Order number 068443

Dimensions (in mm)

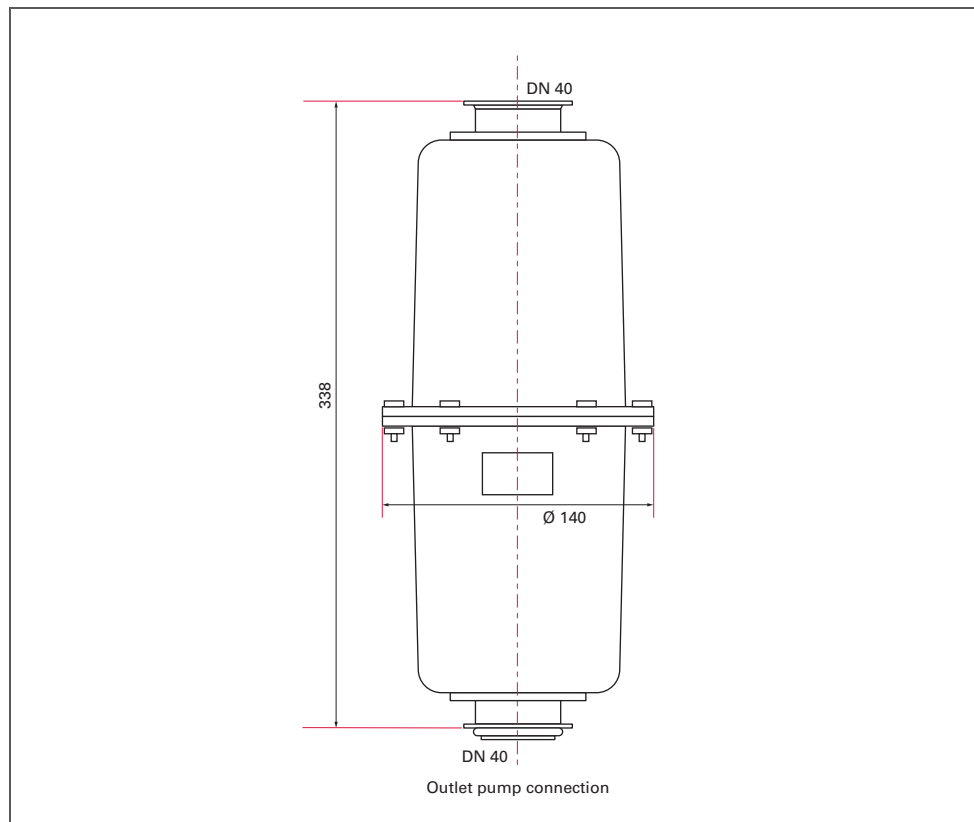

Order number

Oil mist eliminator OME40S

104887



Oil mist eliminator OME40HP+



Oil mist eliminators retain oil mist contained in the exhausted gases with a high level of separation; an internal over pressure valve prevents exceeding the maximum permissible exhaust pressure.

- Body material: Aluminum
- Cartridge material: phenolic resin/glass micro-fiber/polnoter
- Weight: 1.4 kg
- Inlet/Exhaust port: DN 40 ISO-KF
- Supplied with: 1 centering ring and 1 clamp
- Replacement cartridge (single): Order number 115937

Dimensions (in mm)

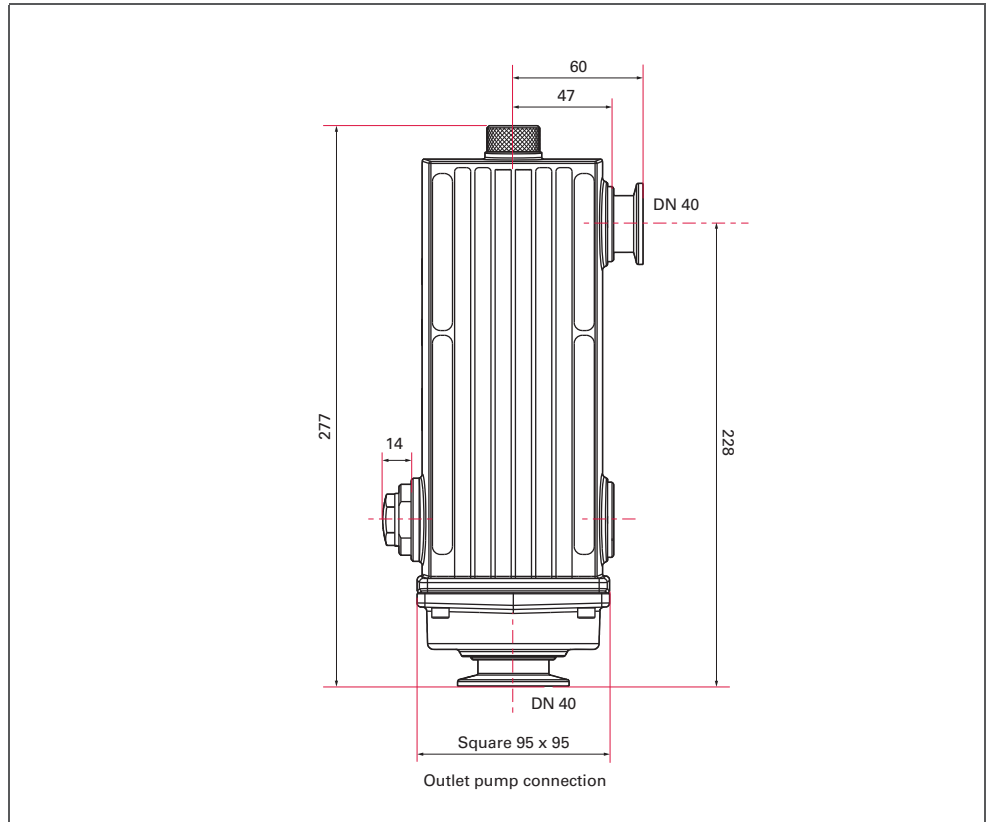

Order number

Oil mist eliminator OME40HP+

200024



Oil mist eliminator OME40C1



Oil mist eliminators retain oil mist contained in the exhausted gases with a high level of separation; an internal over pressure valve prevents exceeding the maximum permissible exhaust pressure.

- Body material: Stainless steel
- Cartridge material: PTFE/glass microfiber
- Weight: 4.1 kg
- Inlet/Exhaust port: DN 40 ISO-KF
- Replacement cartridge (single): Order number 068778

Dimensions (in mm)

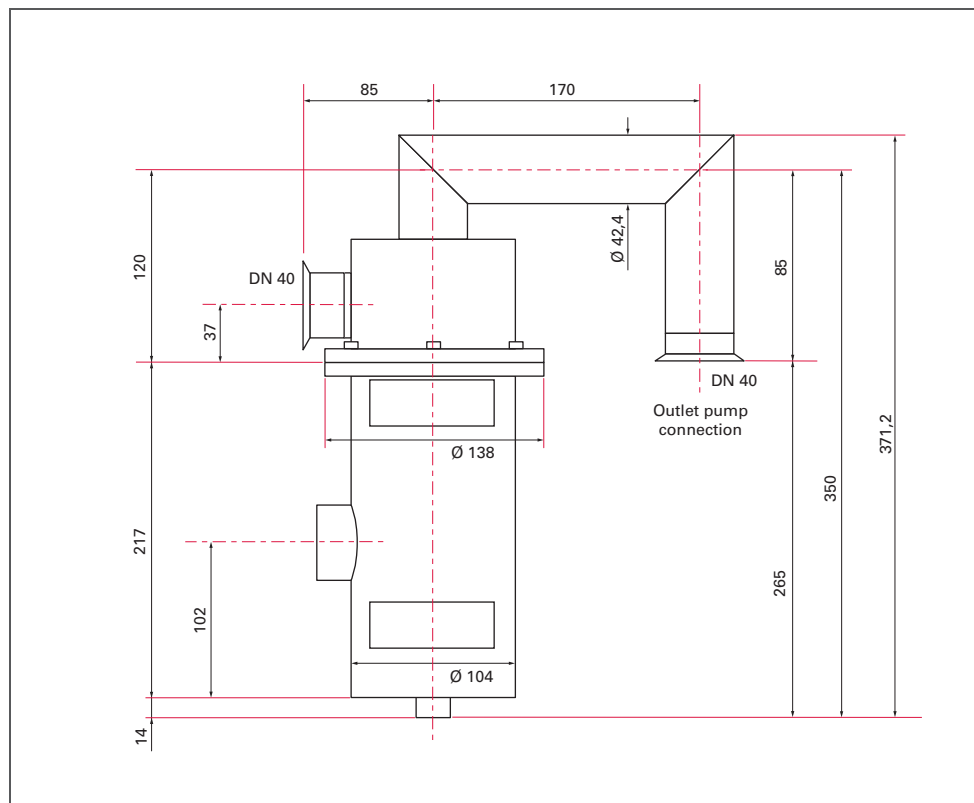

Order number	
Oil mist eliminator OME40C1	068785



Oil mist eliminator OME40C2



Oil mist eliminators retain oil mist contained in the exhausted gases with a high level of separation; an internal over pressure valve prevents exceeding the maximum permissible exhaust pressure.

- Body material: Stainless steel
- Cartridge material: Polypropylene
- Weight: 4.1 kg
- Inlet/Exhaust port: DN 40 ISO-KF
- Replacement cartridge (single): Order number 100802

Dimensions (in mm)

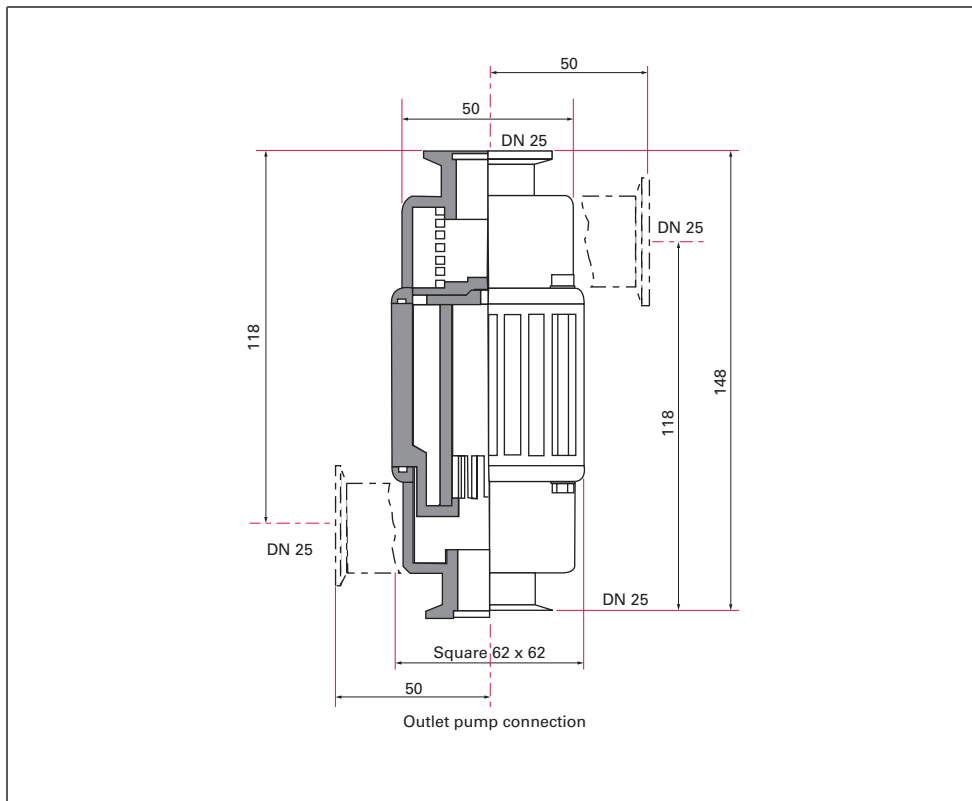

Order number	
Oil mist eliminator OME40C2	068942



Oil drain kit ODK 1

Oil Drain Kit 1 must be used with oil mist eliminator OME 25 HP. It consists of a drain pipe which is connected on one end to the bottom of the OME 25 HP, and on the other end to the inlet of the gas ballast.



- Weight: 0.1 kg

Dimensions (in mm)

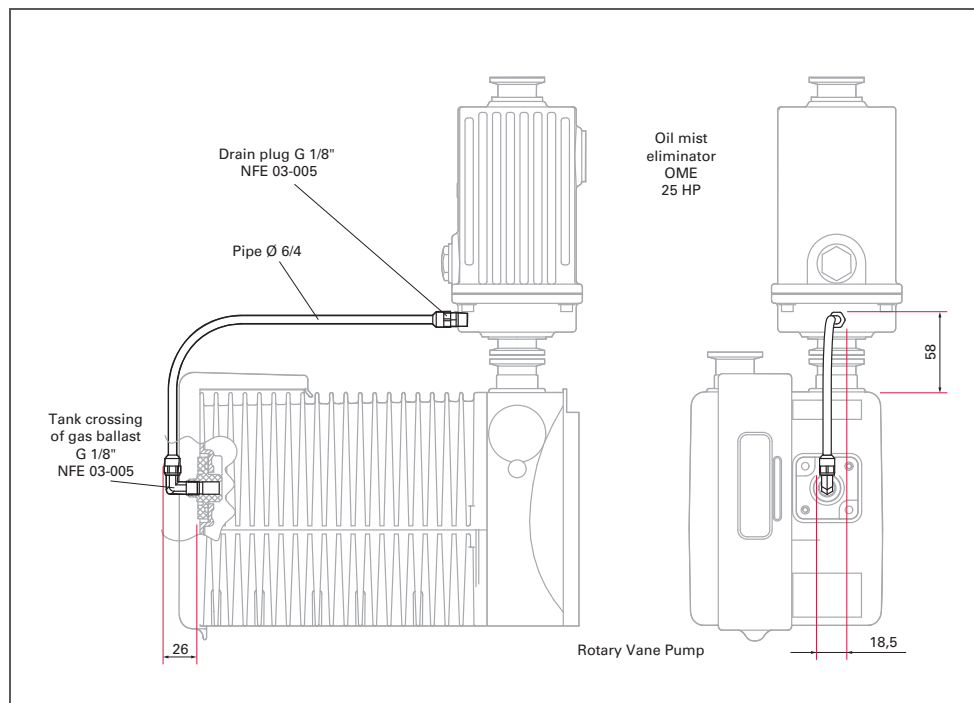

Order number

Oil drain kit ODK 1

104360



Oil drain kit ODK 2

Oil Drain Kit 2 must be used with oil mist eliminator OME 25 HP. It consists of a drain pipe which is connected on one end to the bottom of the OME 25 HP, and on the other end to the inlet of the gas ballast through a solenoid valve. ODK2 are recommended for 5 to 21 m³/h pumps I/SD series.



- Weight: 0.3 kg
- Solenoid Valve Voltage: 230 V 50/60 Hz
- Further voltage ranges are available on request

Dimensions (in mm)

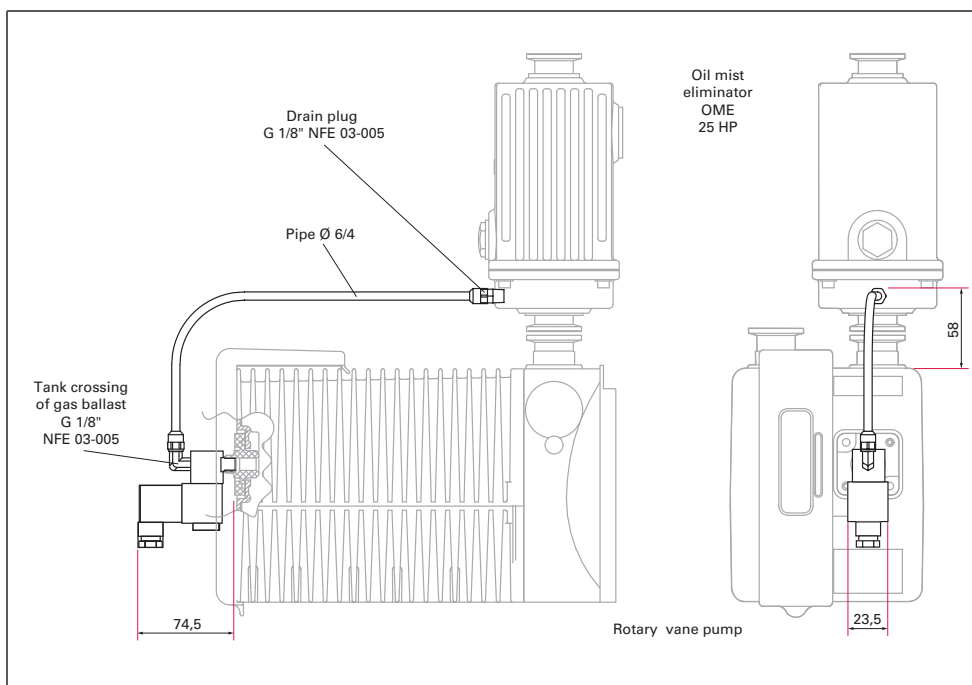

Order number	
Oil drain kit ODK 2	104361



Oil drain kit ODK 136

Oil Drain Kit 136 must be used with oil mist eliminator OME 40 HP+. It consists of a drain pipe which is connected on one end to the bottom of the OME 40 HP+, and on the other end to the inlet of the gas ballast through a solenoid valve.



Dimensions (in mm)

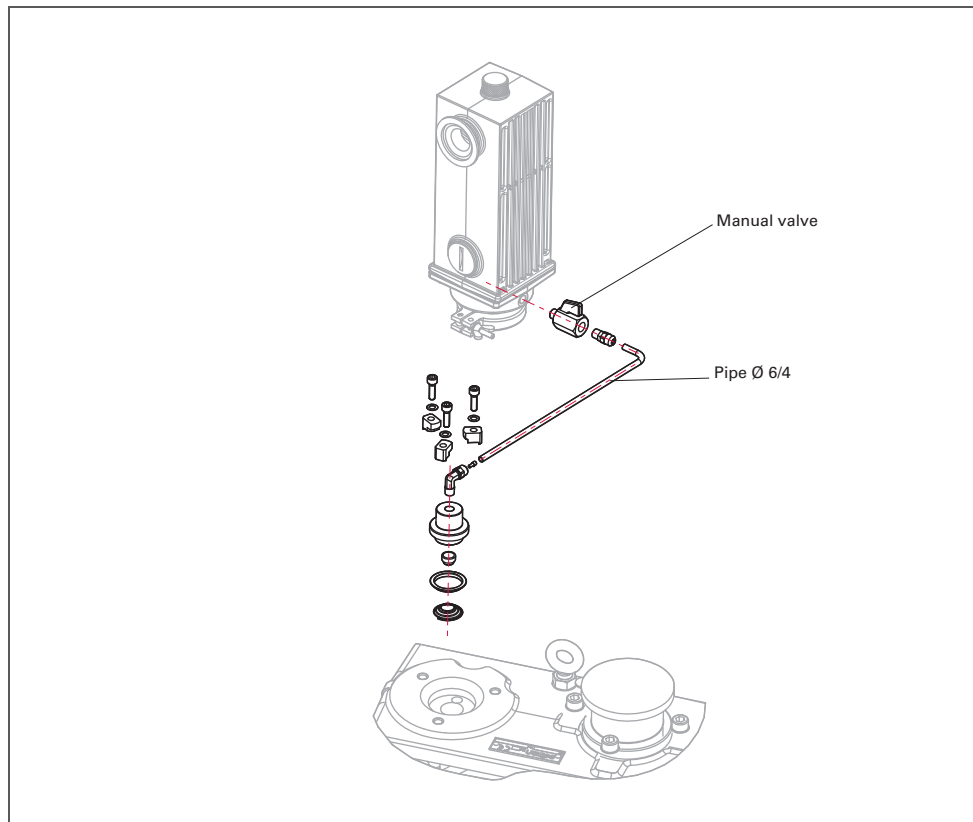

Order number

Oil drain kit ODK 136

118773



Oil drain kit ODK 236

Oil Drain Kit 236 must be used with oil mist eliminator OME 40 HP+. It consists of a drain pipe which is connected on one end to the bottom of the OME 40 HP+, and on the other end to the inlet of the gas ballast through a solenoid valve.



- Solenoid Valve Voltage: 230 V 50/60 Hz
- Further voltage ranges are available on request

Dimensions (in mm)

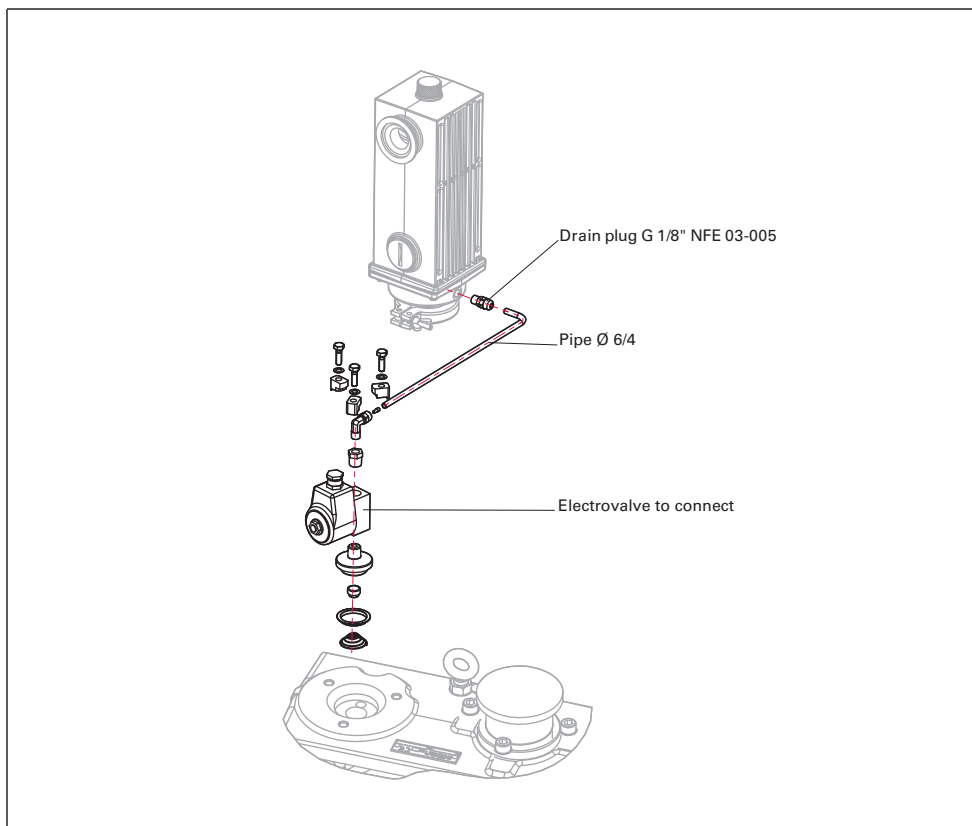

Order number

Oil drain kit ODK 236, 230 V, 50/60 Hz

118776



Sorption trap ST 25 S

Sorption traps consist of a sealed body filled with adsorbent media which contains extremely porous surfaces adsorb water or hydrocarbon molecules contained in the pumped gases.

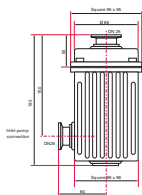

- Body material: Aluminum
- Cartridge material: Stainless steel
- Trap Weight: 1.15 kg
- Adsorbent Weight: 0.36 kg
- Inlet/Exhaust port: DN 25 ISO-KF
- Conductance at 10^{-1} hPa inlet pressure: 45 l/s
- Conductance at 10^{-2} hPa inlet pressure: 11 l/s
- Adsorbent charge: activated alumina: Order number 068779
- Adsorbent charge: zeolite: Order number 068182
- Supplied with: 1 centering ring and 1 clamp

Dimensions (in mm)

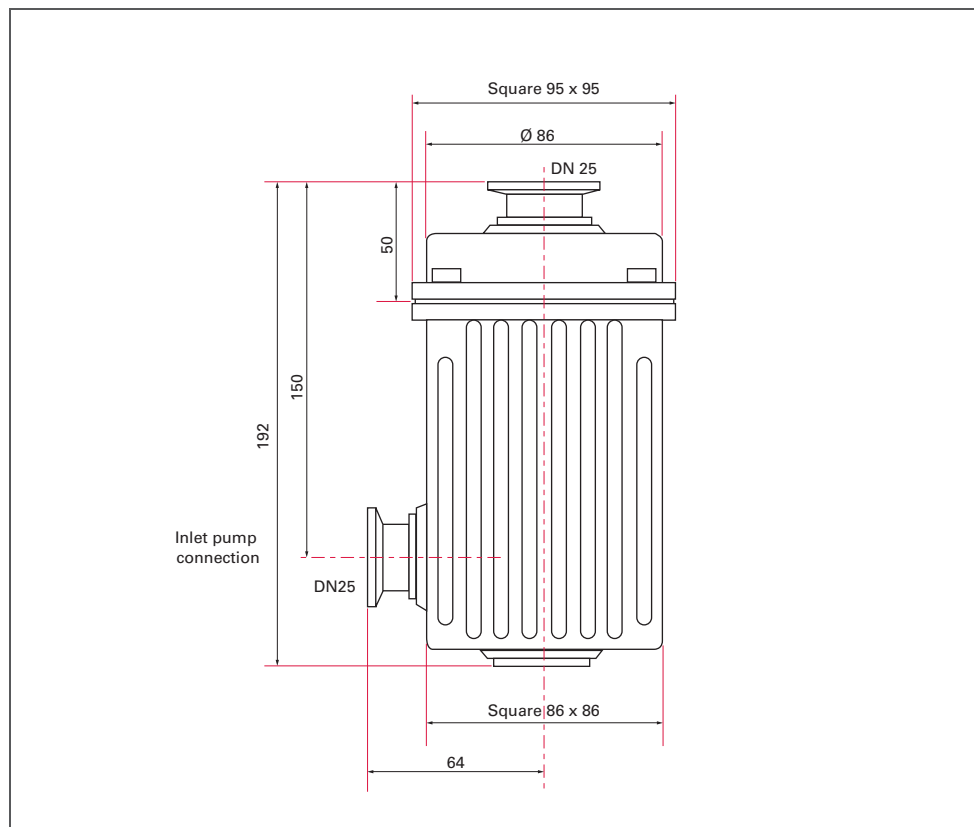

Order number

Sorption trap ST 25 S

104107



Sorption trap ST25C



Sorption traps consist of a sealed body filled with adsorbent media which contains extremely porous surfaces adsorb water or hydrocarbon molecules contained in the pumped gases.

- Body material: Stainless steel
- Cartridge material: Stainless steel
- Trap Weight: 1.4 kg
- Adsorbent Weight: 0.26 kg
- Inlet/Exhaust port: DN 25 ISO-KF
- Conductance at 10^{-1} hPa inlet pressure: 45 l/s
- Conductance at 10^{-2} hPa inlet pressure: 11 l/s
- Adsorbent charge: activated alumina: Order number 068779
- Adsorbent charge: zeolite: Order number 068182
- Heating element: 220 V Order number: 068319
- Supplied with: 1 centering ring and 1 clamp
- Further voltage ranges are available on request

Dimensions (in mm)

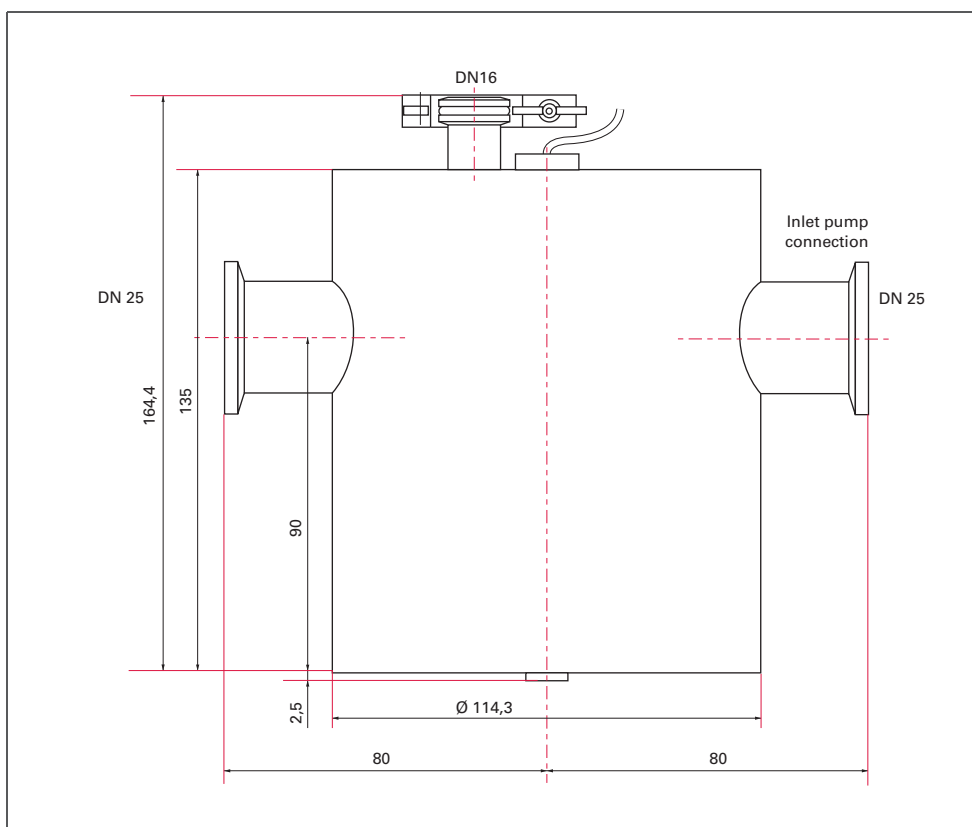

Order number

Sorption trap ST 25 C, 220 V

066841



Sorption trap ST40



Sorption traps consist of a sealed body filled with adsorbent media which contains extremely porous surfaces adsorb water or hydrocarbon molecules contained in the pumped gases.

- Body material: Stainless steel
- Cartridge material: Stainless steel
- Trap Weight: 1.7 kg
- Adsorbent Weight: 0.36 kg
- Inlet/Exhaust port: DN 40 ISO-KF
- Conductance at 10^{-2} hPa inlet pressure: 25 l/s
- Adsorbent charge: activated alumina: Order number 068779
- Adsorbent charge: zeolite: Order number 068182
- Heating element: 220 V Order number: 068319
- Supplied with: 1 centering ring and 1 clamp
- Trap is supplied with zeolite charge
- Further voltage ranges are available on request

Dimensions (in mm)

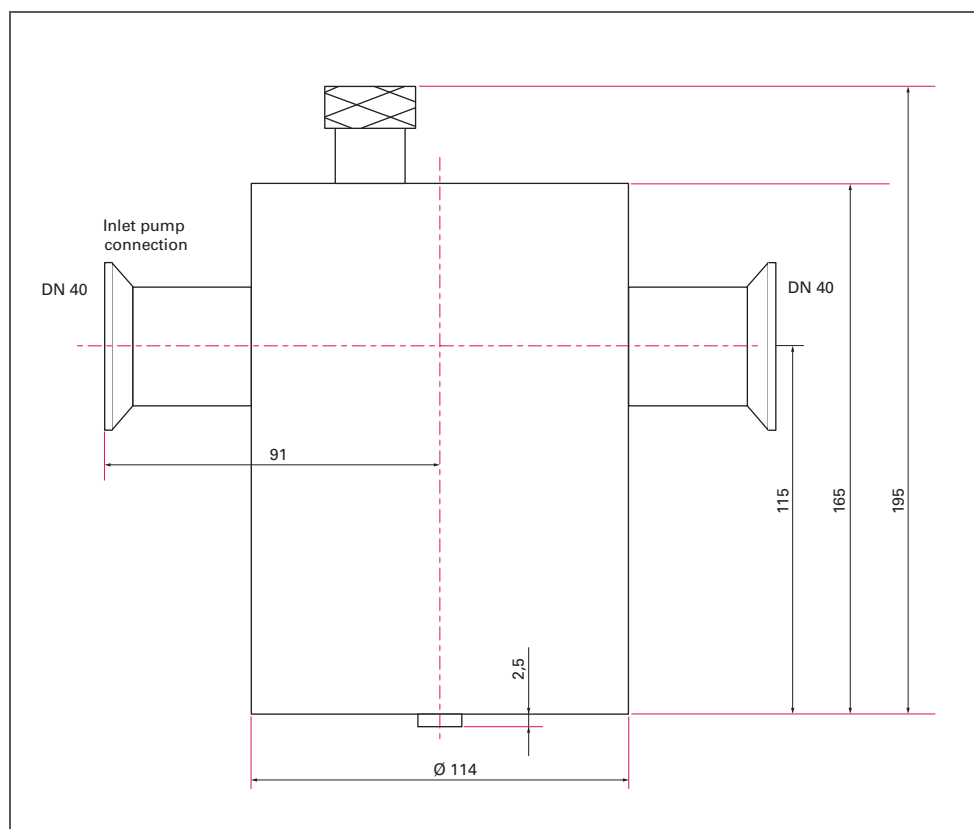

Order number

Sorption trap ST 40, 230 V
(without adsorbend charge)

053380



Inlet dust filter DFT 25



Using inlet dust filters will prevent solid particles from entering into the rotary vane pump and avoid concentration of solid media which can act as an abrasive and shorten the pump lifetime.

- Body material: Polyamide
- Cartridge material: Epoxy/glass microfiber
- Weight: 0.217 kg
- Filtration threshold: 6 μm
- Inlet/Exhaust port: DN 25 ISO-KF
- Conductance at 10^{-2} hPa inlet pressure: 2 l/s
- Conductance at 10^{-2} hPa inlet pressure: 0.6 l/s
- Replacement cartridge (set of 1) Order number 068445
- Supplied with: 1 centering ring, 1 clamp and additional angle port

Dimensions (in mm)

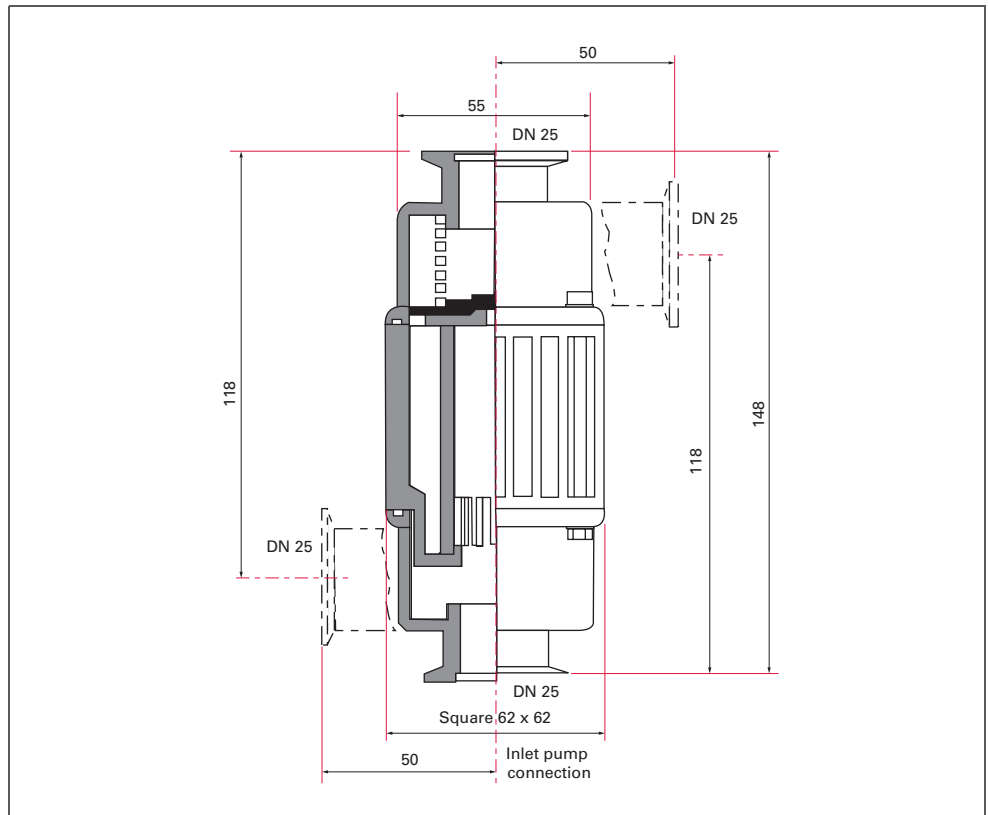

Order number

Inlet dust filter DFT 25

104202



Liquid nitrogen trap LNT 25 S



Liquid nitrogen traps condense all gases at the pump inlet whose critical condensation temperature is above -196°C (77K).

- Body material: Aluminum
- Thimble material: Stainless steel
- Weight: 1.690 kg
- Liquid nitrogen capacity: 0.5 l
- Inlet/Exhaust port: DN 25 ISO-KF
- Conductance at 10^{-1} hPa inlet pressure: 44 l/s
- Conductance at 10^{-2} hPa inlet pressure: 10 l/s
- Fill interval at 10^{-2} hPa inlet pressure: 5 h
- Fill interval at ultimate inlet pressure: 11 h
- Supplied with: 1 centering ring, 1 clamp and additional angle port

Dimensions (in mm)

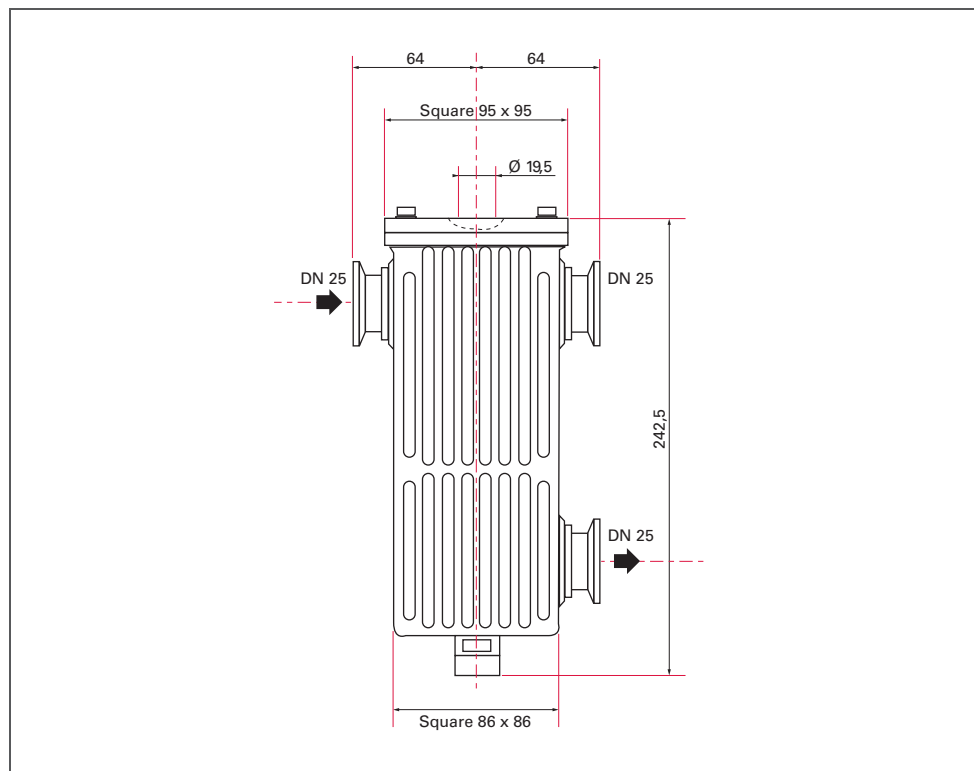

Order number

Liquid nitrogen trap LNT 25 S

104197



Liquid nitrogen trap LNT 25 C



Liquid nitrogen traps condense all gases at the pump inlet whose critical condensation temperature is above -196°C (77K).

- Body material: Stainless steel
- Thimble material: Stainless steel
- Weight: 1.885 kg
- Liquid nitrogen capacity: 0.5 l
- Inlet/Exhaust port: DN 25 ISO-KF
- Conductance at 10^{-1} hPa inlet pressure: 33 l/s
- Conductance at 10^{-2} hPa inlet pressure: 6 l/s
- Fill interval at 10^{-2} hPa inlet pressure: 5 h 30
- Fill interval at ultimate inlet pressure: 14 h
- Supplied with: 1 centering ring and 1 clamp

Dimensions (in mm)

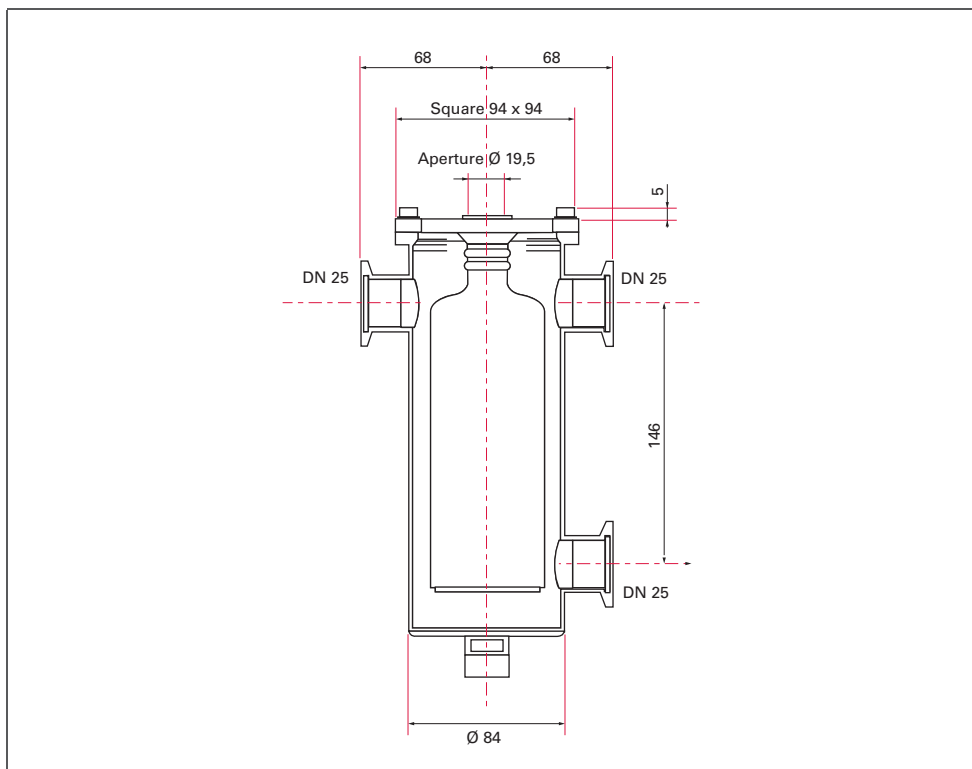

Order number	
Liquid nitrogen trap LNT 25 C	066889



Liquid nitrogen trap LNT 25 P1

Liquid nitrogen traps condense all gases at the pump inlet whose critical condensation temperature is above -196°C (77K).



- Body material: Glass
- Flanges material: Aluminum
- Weight: 1 kg
- Liquid nitrogen capacity: 0.5 l
- Inlet/Exhaust port: DN 25 ISO-KF
- Conductance at 10^{-2} hPa inlet pressure: 6 l/s
- Fill interval at ultimate inlet pressure: 5 h

Dimensions (in mm)

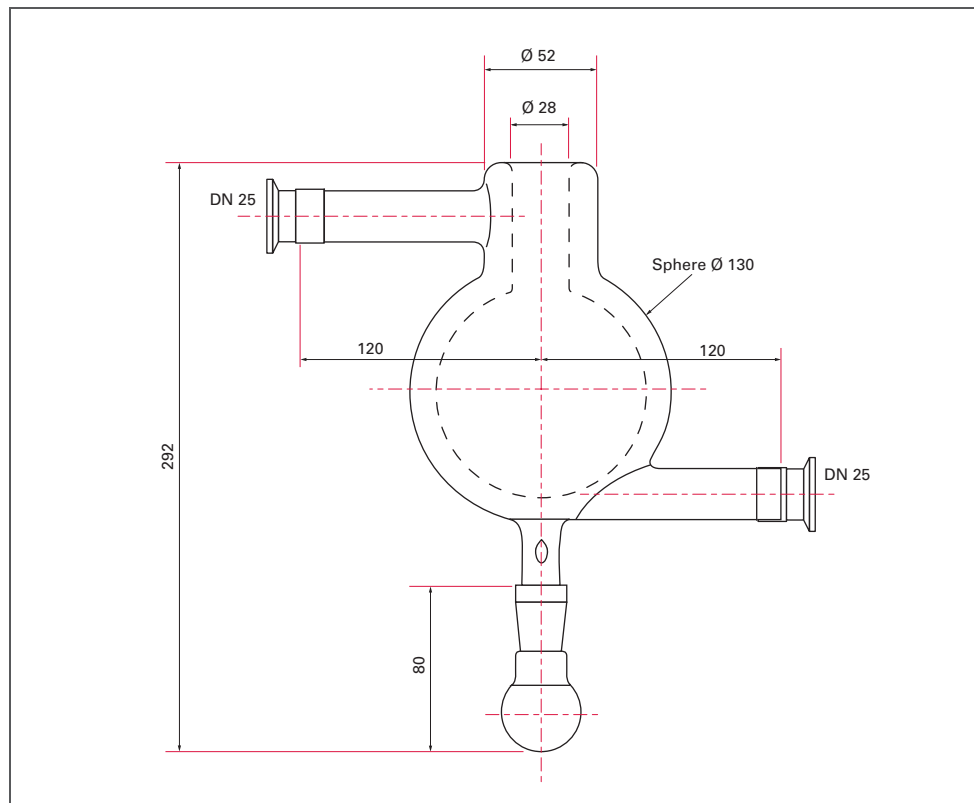

Order number

Liquid nitrogen trap LNT 25 P1

786346



Condensate trap CT 25



Using condensate traps at the pump inlet will prevent introduction of some solid or liquid products (foam, deposits...) which could mix with the oil and reduce pump lifetime.

- Body material: Aluminum
- Filter material: Stainless steel
- Weight: 1.2 kg
- Trap capacity: 0.6 l
- Inlet/Exhaust port: DN 25 ISO-KF
- Conductance at 10^{-1} hPa inlet pressure: 15 l/s
- Conductance at 10^{-2} hPa inlet pressure: 6 l/s
- Replacement filter Order number: 066825
- Supplied with: 1 centering ring and 1 clamp

Dimensions (in mm)

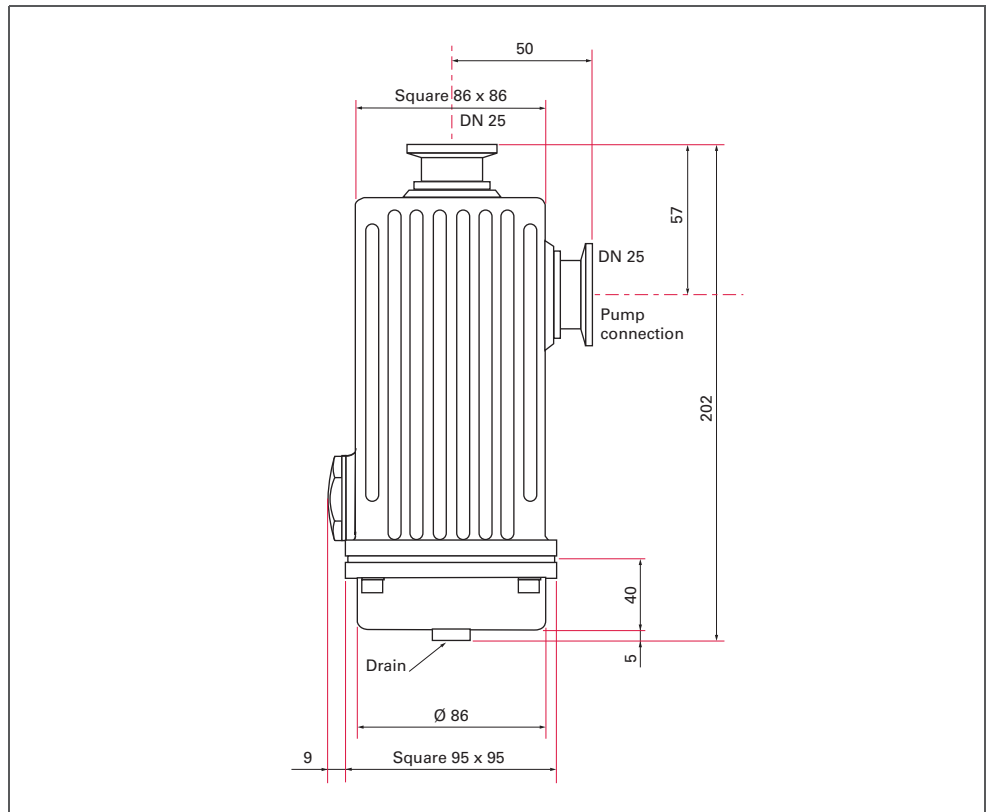

Order number	
Condensate trap CT 25	104201



Automatic gas ballast AGB 4



Electrically operated gas ballast is the remote controlled version of the manual gas ballast of the rotary vane pump. It consists of a Normally Closed solenoid valve which enables air injection into the high pressure stage of the pump.

- Delivered with: 600 mm cable (without plug) all necessary connection parts
- Weight: 0.3 kg
- Spare coil 230 V 50/60 Hz: Order number 103552
- Further voltage ranges are available on request

Dimensions (in mm)

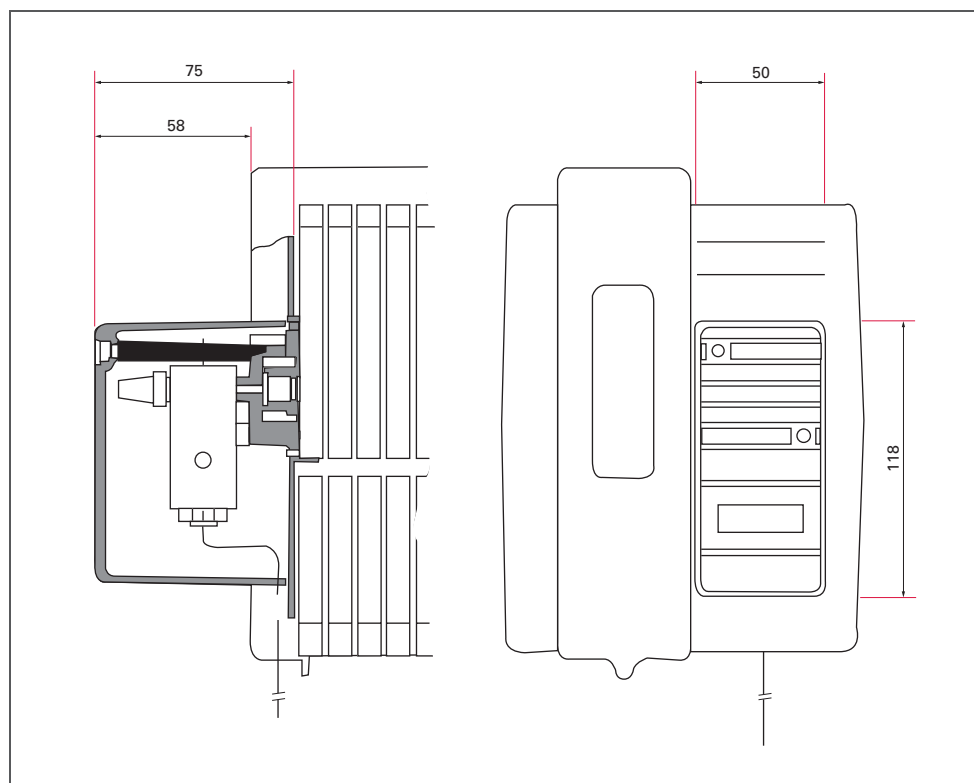

Order number

Automatic gas ballast AGB 4, 230 V, 50/60 Hz

104086



Automatic gas ballast AGB36



Electrically operated gas ballast is the remote controlled version of the manual gas ballast of the rotary vane pump. It consists of a Normally Closed solenoid valve which enables air injection into the high pressure stage of the pump.

- Delivered without cable and plug. All necessary connection parts
- Weight: 0.7 kg
- Spare coil 230 V 50/60 Hz: Order number 104866
- Further voltage ranges are available on request

Dimensions (in mm)

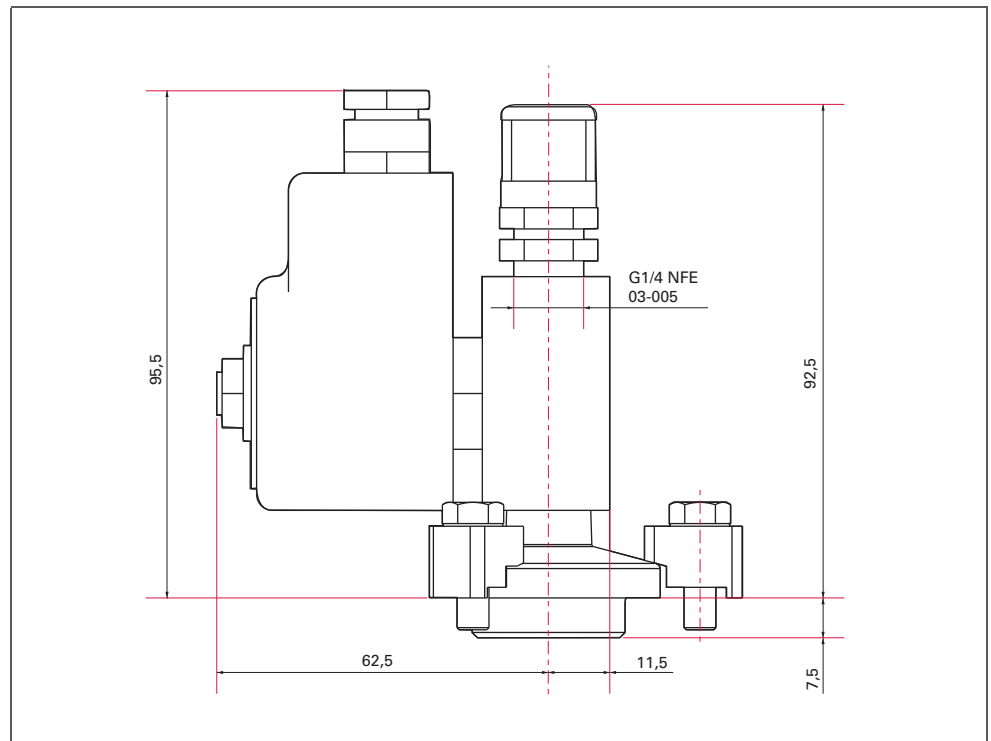

Order number	
Automatic gas ballast AGB 36, 230 V, 50/60 Hz	068391



Oil level switch OLS 4

Oil Level Switch provide information about oil level inside the oil casing of the rotary vane pump.



- Material: Stainless steel/aluminum
- Number of contacts: 2
- Open status when below oil level
- Closed status when above oil level
- Switching capacity: 10 VA 250 V AC/DC 0.5 A
- Cable: 1 m, without plug
- Weight: 0.85 kg
- Supplied with all necessary components for installation on the oil casing.

Dimensions (in mm)

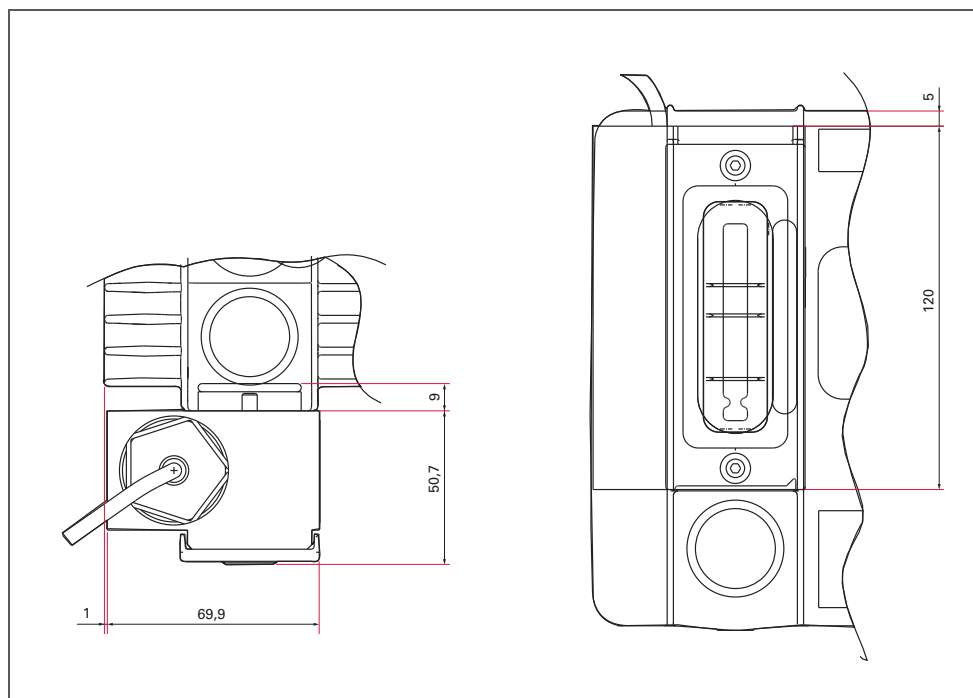

Order number

Oil level switch OLS 4

104376



Oil level switch OLS 36

Oil Level Switch provide information about oil level inside the oil casing of the rotary vane pump.



- Material: Stainless steel/aluminum
- Number of contacts: 2
- Open status when below oil level
- Closed status when above oil level
- Switching capacity: 10 VA 250 V AC/DC 0.5 A
- Cable: 1 m, without plug
- Weight: 1.1 kg
- Supplied with all necessary components for installation on the oil casing.

Dimensions (in mm)

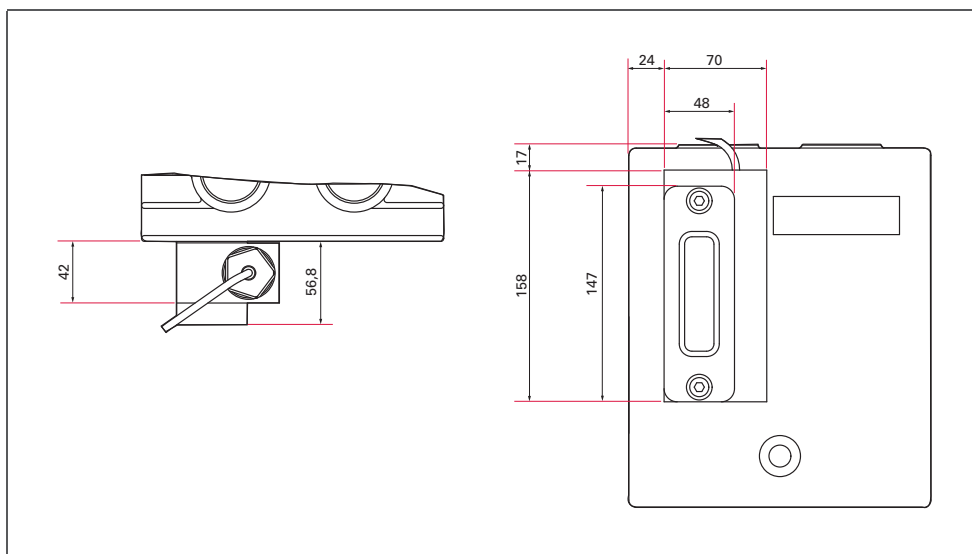

Order number	
Oil level switch OLS 36	104377



External oil filter DE 1



DE filtration system is a stand-alone unit consisting of a magnetically driven gear pump which circulates oil through 1 filtration cartridge.

- Weight: 12 kg
- Mains requirement voltage: 110/220 V, 50 Hz or 115/230 V, 60 Hz
- Hydrocarbon oil flow: 1000 - 1500 cm³/min at 65 °C
- Synthetic oil flow: 1000 cm³/min at 65 °C
- Replacement cartridge activated alumina: Order number: 068880
- Replacement cartridge activated charcoal: Order number: 112953
- Replacement cartridge cellulose: Order number: 078212
- Replacement cartridge cellulose (for USA): Order number: 12633
- Standard factory installed cartridges are activated alumina
- Oil volume: 1.2 l

Dimensions (in mm)

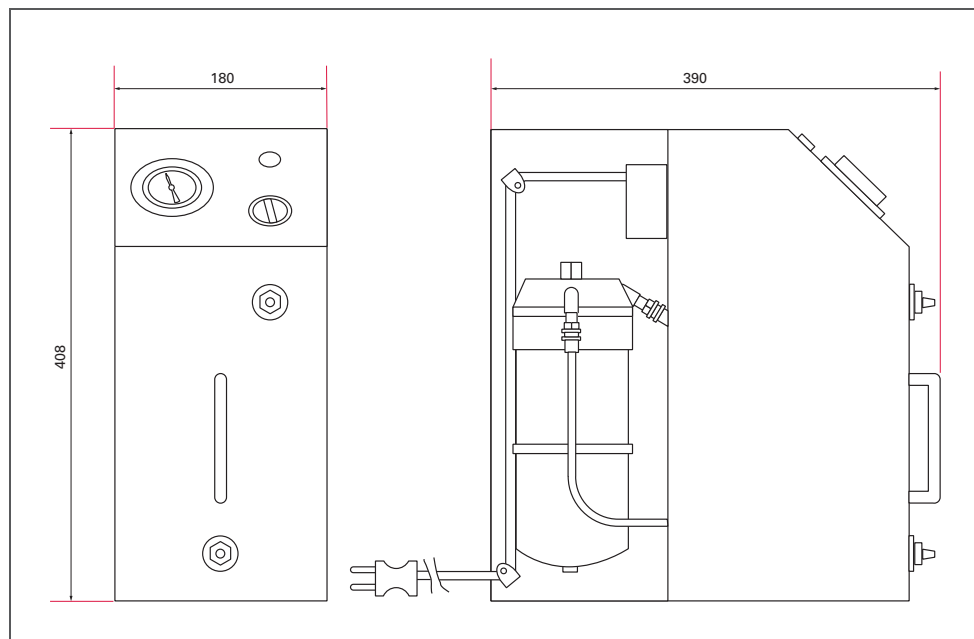

Order number	
External oil filter DE 1, 230 V, 50 Hz	068990



External oil filter DE 2



DE filtration system is a stand-alone unit consisting of a magnetically driven gear pump which circulates oil through 2 filtration cartridges.

- Weight: 17 kg
- Mains requirement voltage: 110/220 V, 50 Hz or 115/230 V, 60 Hz
- Hydrocarbon oil flow: 1000 - 1500 cm³/min at 65 °C
- Synthetic oil flow: 1000 cm³/min at 65 °C
- Replacement cartridge activated alumina: Order number: 068880
- Replacement cartridge activated charcoal: Order number: 112953
- Replacement cartridge cellulose: Order number: 078212
- Replacement cartridge cellulose (for USA): Order number: 12633
- Standard factory installed cartridges are activated alumina
- Oil volume: 1.8 l

Dimensions (in mm)

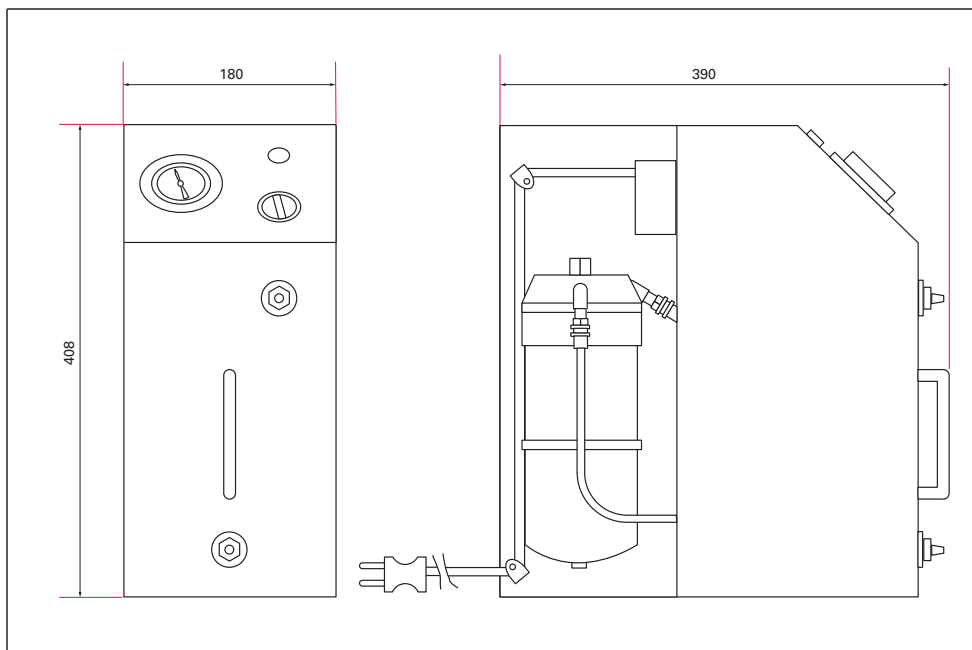

Order number

External oil filter DE 2, 230 V, 50 Hz

104374



